

Two Post Lift Manual

DP15, DP15-2

Capacity 15,000 lbs.

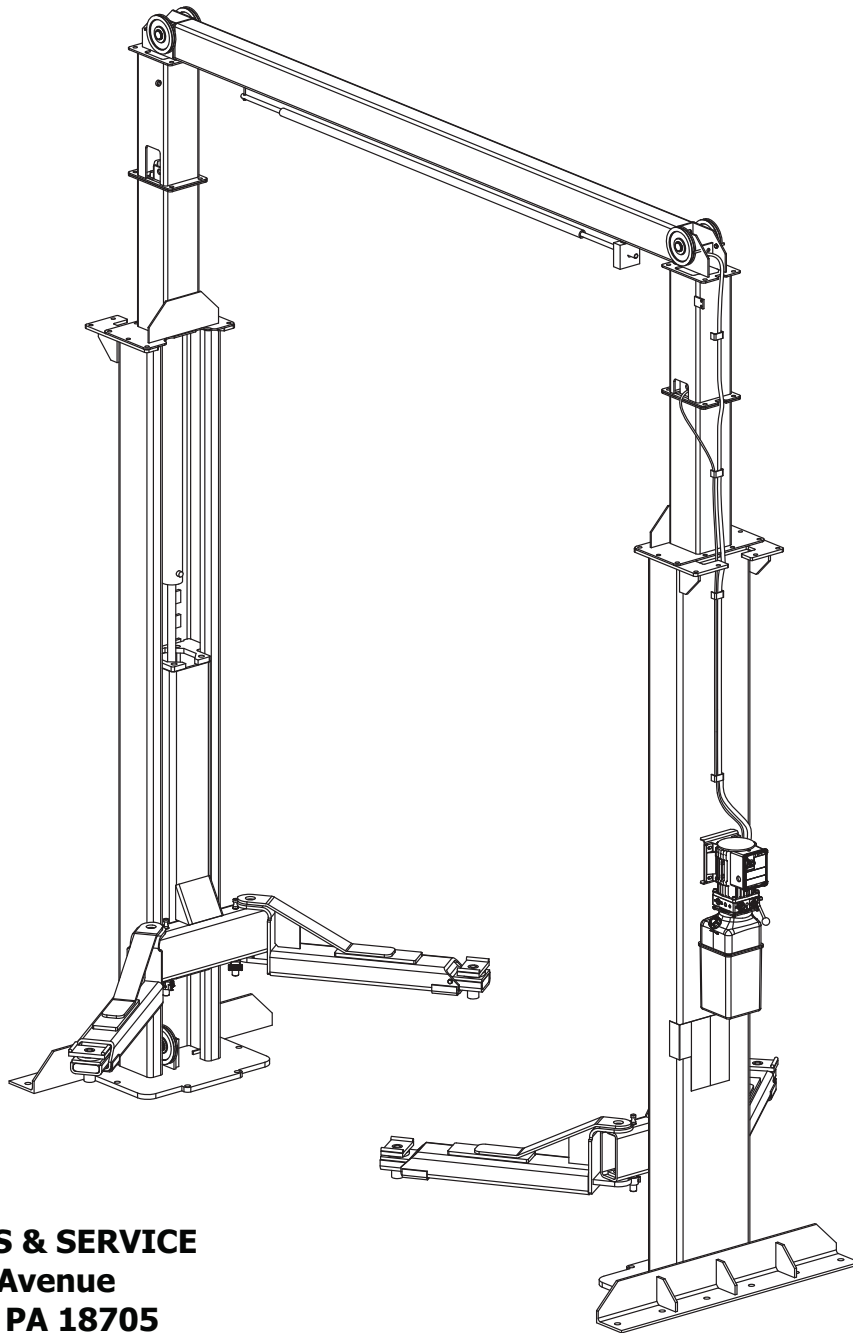

PANZITTA SALES & SERVICE
72 George Avenue
Wilkes-Barre, PA 18705
570-822-6720 800-822-6720
www.panzittasales.com

▲ IMPORTANT Reference ANSI/ALI ALIS, Safety Requirements for Installation and Service of Automotive Lifts before installing lift.

OPERATING CONDITIONS

Lift is not intended for outdoor use and has an operating ambient temperature range of
41°-104°F (5°-40°C)

Parks Breakdown

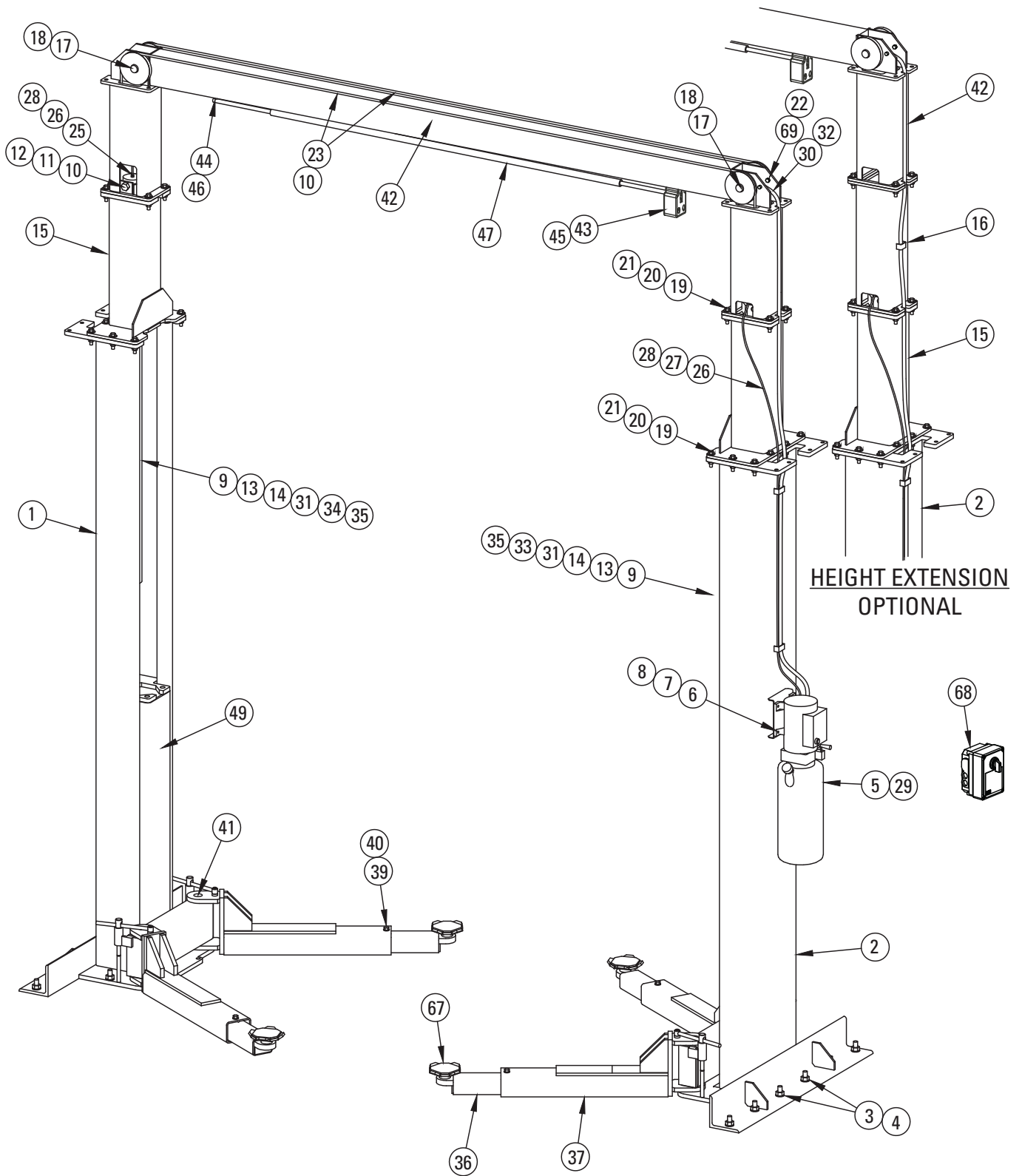

Figure 16

PANZITTA SALES & SERVICE
72 George Avenue
Wilkes-Barre, PA 18705
570-822-6720 800-822-6720
www.panzittasales.com

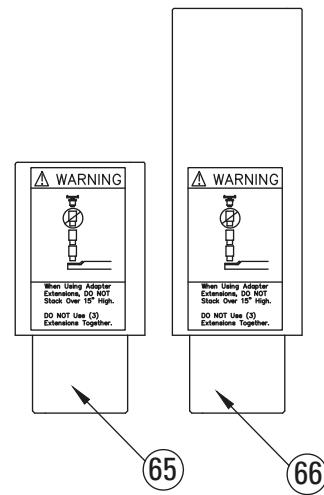
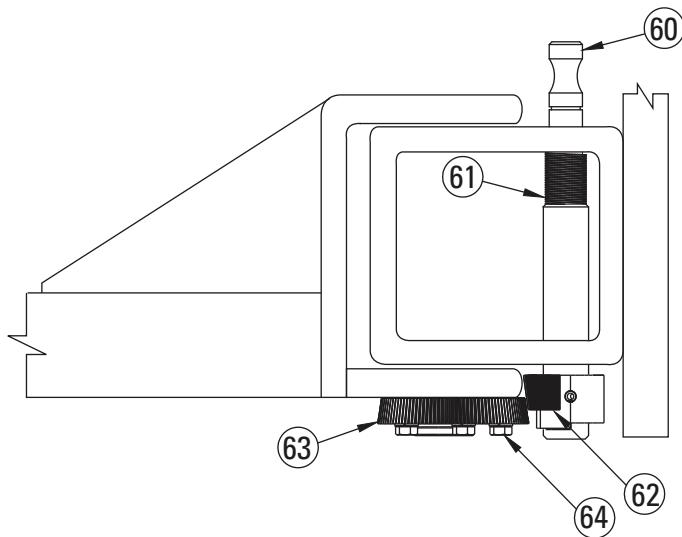
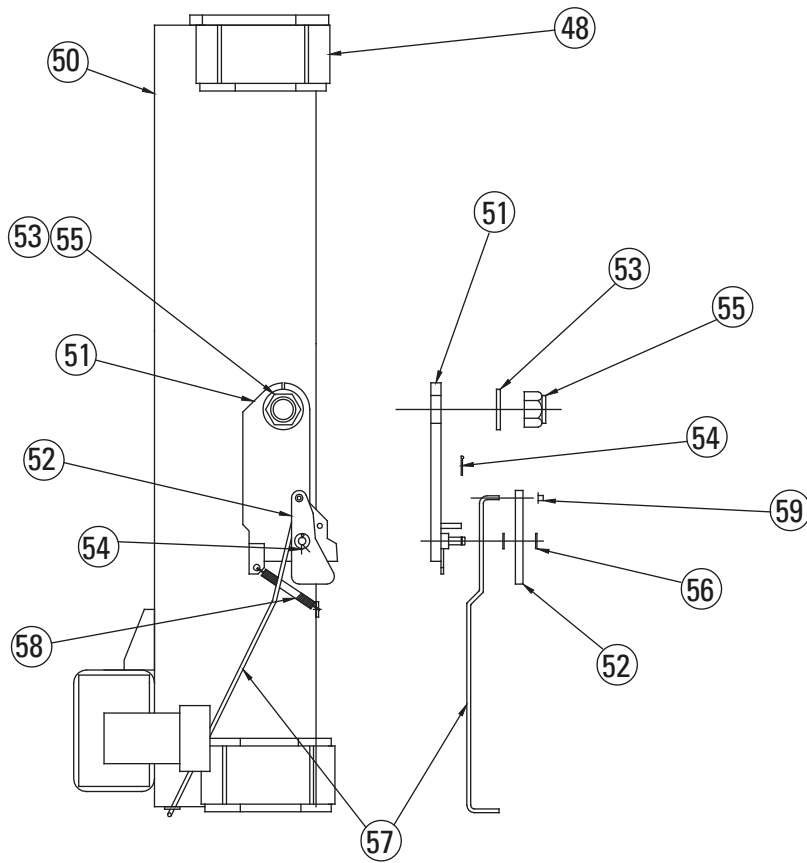

Figure 17

PANZITTA SALES & SERVICE
72 George Avenue
Wilkes-Barre, PA 18705
570-822-6720 800-822-6720
www.panzittasales.com

Item	Description	Part No.	Item	Description	Part No.
1	Offside Leg	137201	34	Offside Hose	
2	Mainside Leg	137101		Standard Height	992167
3	Shim	991127		2' Extended Height	992173
4	3/4" X 5-1/2" Anchor Bolt	913828	35	24" Wire Tie	991082
5	Power Unit, 1Ø	P3403	36	Swing Arm Assembly	1580625
	Power Unit, 3Ø	P3416	37	Swing Arm Slider Weldment	1580605
6	5/16-18 Hex Nut	911701	38	Swing Arm Tube Weldment	1580623
7	5/16-18 Nylon Insert Lock Nut	911703	39	1/2-13 X 3/4 HHCS Grade 5	912631
8	5/16-18 X 1-1/4" HHCS Grade 5	911751	40	1/2 Lock Washer	912607
9	Cylinder	992322	41	Arm Pin	996744
10	3/4-16 Nylon Insert Lock Nut	913604	42	Overhead Weldment	137802
11	3/4-16 X 5 HHCS Grade 8	913882		1' Reduced Hgt Overhead Weldment	1581800
12	3/4" SAE Washer	913606	43	Overhead Switch	N413
13	1" Hex Nut	914402	44	Switch Bar Spacer	991480
14	1" Hex Jam Nut	914411	45	HWHTS Type F, 10-24 X1/2"	991482
15	Upright	137801	46	HWHTS Type F, 10-24 X 1-3/4"	991483
16	Extension	137803	47	Padded Overhead Switch Bar 1Ø	991481
17	1-3/8 Snap Ring	991030		Overhead Switch Bar, 3Ø	N434
18	5" Cable Sheave	995030	48	Rub Block	996390
19	1/2-13 X 2-1/2 HHCS Grade 5	912701	49	Carriage Assembly	137530
20	1/2-13 Hex Nut	912601	50	Carriage Weld	137531
21	1/2 Washer	912605	51	Latch Weldment	137502
22	5/16"-18NC x 1 1/2" HHCS Grade 5	40271	52	Latch Wipeout	70528
23	Cable		53	1/1/8" SAE Washer	914806
	Standard Height	992626	54	3/8 Ext. Retaining Ring	41410
	2' Extended Height	992629	55	1-1/8"-12 Nylon Lock Nut	914804
24	NA	NA	56	3/8" Washer	912005
25	Offside Return Line Fitting	992504	57	Latch Pull Rod	90541
26	1/4" Return Line	992212	58	Latch Spring	991071
27	Mainside Return Line Tee	992505	59	3/16 Cap Nut	991070
28	3/8" Bushing to 1/4" NPT Bushing	992501	60	Restraint Pin	137536
29	9/16 O-Ring to 3/8 JIC Elbow	992410	61	Restraint Spring	143537
30	3/8 JIC Tee	992502	62	Gear Block	143535
31	3/8 JIC to 3/8 NPT Elbow	992402	63	Restraint Gear	1280612
32	Power Unit Hose		64	3/8"-16NC x 1-1/2" lg. HHCS & Lock Washer	912061
	Standard Height	992103	65	5" Extension Assembly	1580614
	2' Extended Height	992170	66	10" Extension Assembly	1580615
33	Mainside Hose		67	Adapter Assembly	1580613
	Standard Height	992180	68	Drum Switch Box Assembly, 3Ø	FA7366
	2' Extended Height	992172	69	5/16" Lock Washer	40850

PANZITTA SALES & SERVICE
72 George Avenue
Wilkes-Barre, PA 18705
570-822-6720 800-822-6720
www.panzittasales.com

PANZITTA SALES & SERVICE
72 George Avenue
Wilkes-Barre, PA 18705
570-822-6720 800-822-6720
www.panzittasales.com



© **Vehicle Service GroupSM**
All Rights Reserved. Unless otherwise
indicated, **Vehicle Service GroupSM**
and all other trademarks are property
of Dover Corporation and its affiliates.