

MOHAWK



PARTS

MP-18-24VDC-SERIES

ELECTRIC/HYDRAULIC

PORTABLE LIFT

PANZITTA SALES & SERVICE
72 George Avenue
Wilkes-Barre, PA 18705
570-822-6720 800-822-6720
www.panzittasales.com

24 VDC W/15" FORKS

| # | DESCRIPTION | DATE | APPROVED |
|---|---|------------|----------|
| A | ITEM 10 WAS MP-5400-A-003 | 07/15/2008 | DM |
| B | REMOVED HOOK ITEM 2 FROM LEFT SIDE REMOVED ASSOCIATED HARDWARE ITEMS 25 & 31 | 06/08/2010 | G. GORE |
| C | ITEM 1 WAS MP-0400-A-003 | 07/21/2011 | G.GORE |
| D | ITEM 12 WAS MP-5100-A-005 | 08/02/2011 | G.GORE |

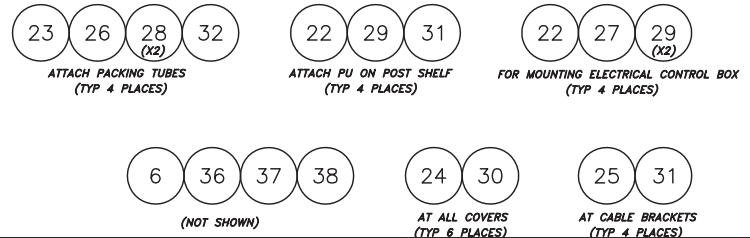
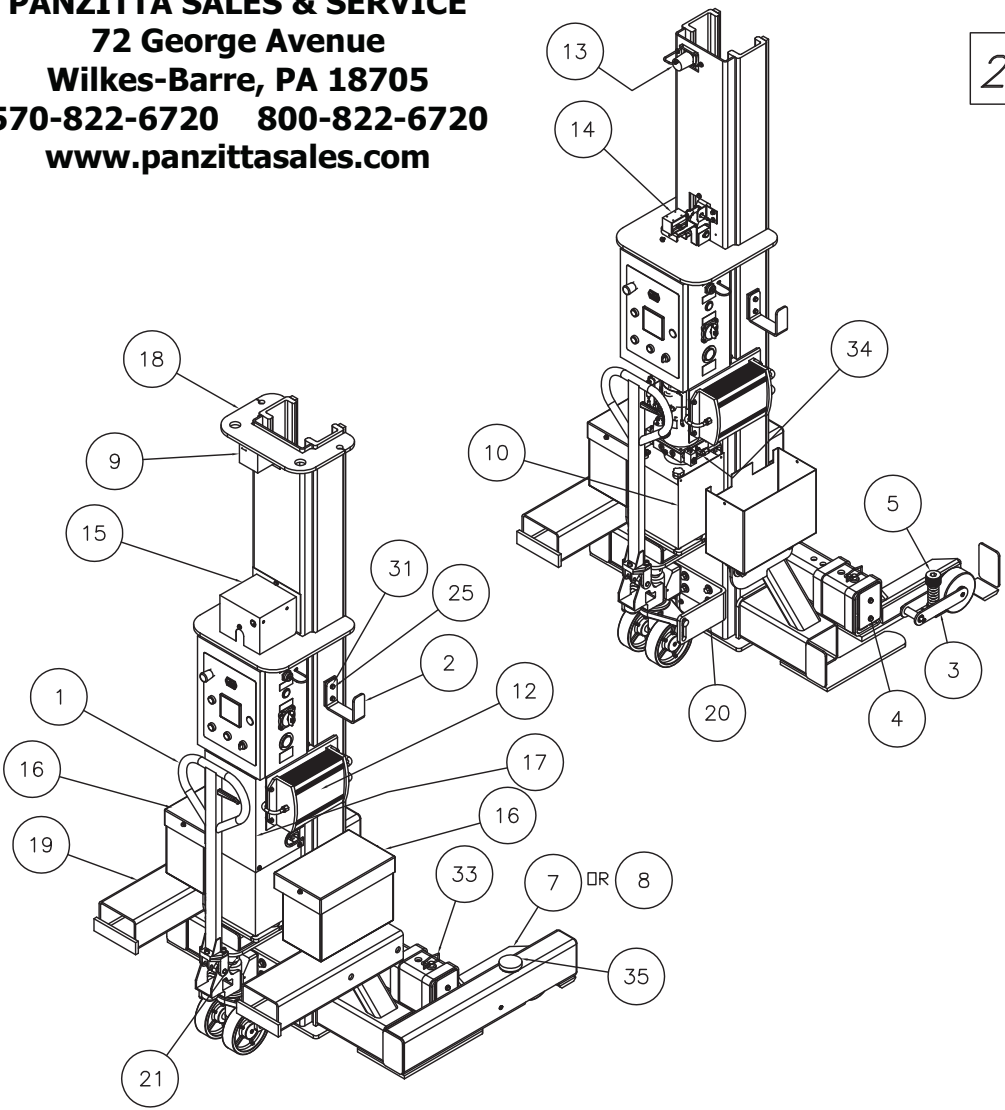

| ITEM | NAME | DESCRIPTION | QTY | MATERIAL | VENDOR | NOTE | MASS | PRICE |
|------|---------------|---|-----|-------------|--------|----------------------------|------|---------|
| 38 | MP-5400-A-011 | Tag & Decal Location, MP-24VDC | 1 | | | | | 0.000 |
| 37 | MP-5100-A-011 | Cable Assy, 40" Lg, Black | 1 | | | | | 1.000 |
| 36 | MP-5100-A-010 | Cable Assy, 36" Lg, Red | 1 | | | | | 1.000 |
| 35 | 601-460-005 | Cap, Plastic, Red, 3" Dia x 1/2 Thk | 2 | | | Caplugs #EC-48 | | 0.020 |
| 34 | 601-420-017 | Elbow, 90 Deg, #6 ORB to #6 JIC | 1 | | | Aerquip #2062-6-6S | | 0.100 |
| 33 | 600-900-006 | Hitch Pin, 3/4 Dia | 2 | | | McMaster #98497A864 | | 0.750 |
| 32 | 600-720-008 | Washer, Lock, 3/4 | 4 | | | | | 0.040 |
| 31 | 600-720-002 | Washer, Lock, 5/16 | 6 | | | | | 0.004 |
| 30 | 600-710-004 | Washer, Flat, 1/4 | 6 | | | | | 0.005 |
| 29 | 600-710-003 | Washer, Flat, 5/16 | 12 | | | | | 0.005 |
| 28 | 600-710-001 | Washer, Flat, 3/4 | 8 | | | | | 0.110 |
| 27 | 600-690-001 | Nut, Nylon Lock, 5/16-18 NC | 4 | | | | | 0.010 |
| 26 | 600-680-005 | Nut, Plain, 3/4-16 NF | 4 | | | | | 0.120 |
| 25 | 600-640-053 | Bolt, Hex Head, 5/16-18 NC x 1/2 Lg (Gr 5) | 2 | | | | | 0.020 |
| 24 | 600-640-039 | Bolt, Hex Head, 1/4-20 NC x 3/8 Lg (Gr 5) | 6 | | | | | 0.010 |
| 23 | 600-640-003 | Bolt, Hex Head, 3/4-16 NF x 2 1/2" (GR5) | 4 | | | | | 0.500 |
| 22 | 600-640-001 | Bolt, Hex Head, 5/16-18 NC x 1 1/4" Lg (Gr 5) | 8 | | | | | 0.040 |
| 21 | 600-630-003 | Set Screw, 1/4-20 NC x 1/2 Lg | 1 | | | | | 0.010 |
| 20 | P-150-P-004 | Access Hole Cover | 1 | 600-030-008 | | 10ga x 3 1/4" x 6" | | 0.730 |
| 19 | MP-5400-W-001 | Packing Tube Weldment (24V) | 2 | | | | | 39.760 |
| 18 | MP-5300-W-003 | Leg Secondary Weldment, 24 VDC | 1 | | | | | 747.000 |
| 17 | MP-5300-A-002 | PU Cover Assy (24 VDC) | 1 | | | | | 8.000 |
| 16 | MP-5300-A-001 | Battery Box Assy | 2 | | | | | 85.600 |
| 15 | MP-5200-P-001 | Lock Cover | 1 | 600-030-014 | | 16 Gauge | | 3.460 |
| 14 | MP-5200-A-001 | Lock Release Assy, 24 VDC | 1 | | | | | 6.800 |
| 13 | MP-5100-A-014 | String Pot Assembly, ANALOG | 1 | | | | | 0.700 |
| 12 | MP-5100-A-012 | Charger Assembly | 1 | | | | | 24.750 |
| 11 | MP-5100-A-001 | Master Box Assy | 1 | | | | | |
| 10 | MP-5400-A-014 | Power Unit Assy, 24 VDC (8-2008) | 1 | | | | | 75.000 |
| 9 | MP-1100-P-003 | Sensor Cover | 1 | 600-030-014 | | 16 Gauge | | 1.000 |
| 8 | MP-1000-W-006 | Fork Weldment, Right | 1 | | | | | 62.300 |
| 7 | MP-1000-W-005 | Fork Weldment, Left | 1 | | | | | 67.300 |
| 6 | MP-0900-A-001 | Cylinder Assembly | 1 | | | | | 126.000 |
| 5 | MP-0800-P-024 | Threaded Spring Retainer | 2 | 600-090-019 | | 2" Dia x 2 1/2 Lg | | 1.170 |
| 4 | MP-0700-A-001 | Carriage Assembly | 1 | | | | | 290.000 |
| 3 | MP-0500-A-001 | Floor Roller Assembly | 2 | | | | | 7.840 |
| 2 | MP-0400-P-002 | Cable Hook | 1 | 600-010-027 | | 1/4 x 2" (Flat) x 13" Long | | 1.850 |
| 1 | MP-0400-A-007 | JACK ASSEMBLY | 1 | | | | | |

NOTICE OF CONFIDENTIAL INFORMATION
 INFORMATION CONTAINED HEREIN IS CONFIDENTIAL AND PROPERTY OF MOHAWK RESOURCES LTD. WHERE DRAWING IS FURNISHED TO OTHERS IT SHALL BE USED SOLELY FOR PURPOSES OF INSPECTION, INSTALLATION, OR MAINTENANCE. THE INFORMATION SHALL NOT BE USED OR DISCLOSED BY THE RECIPIENT FOR ANY OTHER PURPOSES WHATSOEVER.

NOTES:
 1. REMOVE ALL SHARP CORNERS & EDGES.
 2. UNLESS OTHERWISE SPECIFIED, SURFACE FINISH TO BE 125 RMS.
 3. WELDING MEDIUM SHALL CONFORM TO AWS SPECIFICATIONS TO E-70XX ELECTRODES OR E-70T1 CODE 53 FLUX CORE WIRE ONLY.

TOLERANCES:
 ANGULAR ± 1°
 FRACTIONAL ± .030
 DECIMAL ± .030
 DIA ± .005
 HOLE ± .005
 FILE NAME
 MP-5400-A-001.dwg

| SCALE | DRAWN | CHECKED | APPROVED | TITLE | DATE | WEIGHT | FROM | DRAWING NUMBER |
|-----------|---------|---------|----------|--|------|--------|------|----------------|
| 1'0"=1'0" | rwv7089 | | | MOHAWK RESOURCES LTD. MP-24VDC-SERIES Master Post Assembly | 4/07 | 1700 | N/A | MP-5400-A-001 |

D-SIZE

PANZITTA SALES & SERVICE
72 George Avenue
Wilkes-Barre, PA 18705
570-822-6720 800-822-6720
www.panzittasales.com

24 VDC W/22" FORKS
WIDER

| # | DESCRIPTION | DATE | APPROVED |
|---|-------------------------------|------------|----------|
| A | ITEM 38 (MP-5400-A-017) ADDED | 03/24/2010 | dak0879 |
| B | ITEM 1 WAS MP-0400-A-003 | 07/21/2011 | G.GORE |
| C | Item 12 Was MP-5100-A-005 | 08/02/2011 | G.GORE |

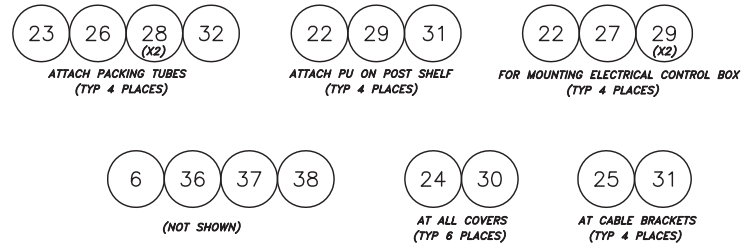
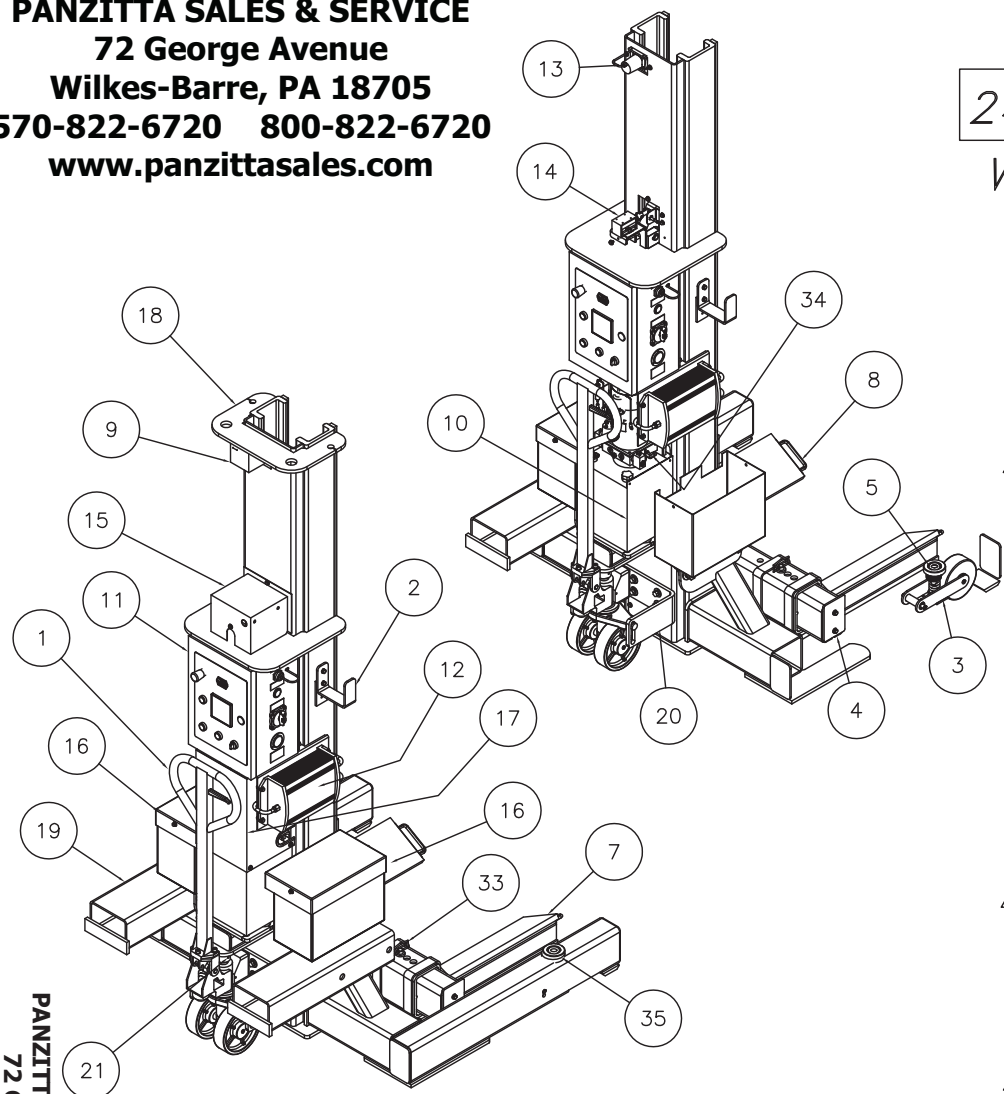

| ITEM | NAME | DESCRIPTION | QTY | MATERIAL | VENDOR | NOTE | MASS | PRICE |
|------|---------------|---|-----|-------------|--------|----------------------------|------|---------|
| 38 | MP-5400-A-017 | Tag & Decal Location | 1 | | | | | 0.000 |
| 37 | MP-5100-A-011 | Cable Assy, 40" Lg, Black | 1 | | | | | 1.000 |
| 36 | MP-5100-A-010 | Cable Assy, 36" Lg, Red | 1 | | | | | 1.000 |
| 35 | 601-460-005 | Cap, Plastic, Red, 3" Dia x 1/2 Thk | 2 | | | Caplugs #EC-48 | | 0.020 |
| 34 | 601-420-017 | Elbow, 90 Deg, #6 ORB to #6 JIC | 1 | | | Aeroquip #2062-6-6S | | 0.100 |
| 33 | 600-900-006 | Hitch Pin, 3/4 Dia | 2 | | | McMaster #98497A664 | | 0.750 |
| 32 | 600-720-008 | Washer, Lock, 3/4 | 4 | | | | | 0.040 |
| 31 | 600-720-002 | Washer, Lock, 5/16 | 8 | | | | | 0.004 |
| 30 | 600-710-004 | Washer, Flat, 1/4 | 6 | | | | | 0.005 |
| 29 | 600-710-003 | Washer, Flat, 5/16 | 12 | | | | | 0.005 |
| 28 | 600-710-001 | Washer, Flat, 3/4 | 8 | | | | | 0.110 |
| 27 | 600-690-001 | Nut, Nylon Lock, 5/16-18 NC | 4 | | | | | 0.010 |
| 26 | 600-680-005 | Nut, Plain, 3/4-16 NF | 4 | | | | | 0.120 |
| 25 | 600-640-053 | Bolt, Hex Head, 5/16-18 NC x 1/2 Lg (Gr 5) | 4 | | | | | 0.020 |
| 24 | 600-640-039 | Bolt, Hex Head, 1/4-20 NC x 3/8 Lg (Gr 5) | 6 | | | | | 0.010 |
| 23 | 600-640-003 | Bolt, Hex Head, 3/4-16 NF x 2 1/2" (GR5) | 4 | | | | | 0.500 |
| 22 | 600-640-001 | Bolt, Hex Head, 5/16-18 NC x 1 1/4" Lg (Gr 5) | 8 | | | | | 0.040 |
| 21 | 600-630-003 | Set Screw, 1/4-20 NC x 1/2 Lg | 1 | | | | | 0.010 |
| 20 | P-150-P-004 | Access Hole Cover | 1 | 600-030-008 | | 10ga x 3 1/4" x 6" | | 0.730 |
| 19 | MP-5400-W-001 | Packing Tube Weldment (24V) | 2 | | | | | 39.760 |
| 18 | MP-5300-W-006 | Leg Secondary Weldment, 24 VDC (22" Forks)WIDER | 1 | | | | | 746.600 |
| 17 | MP-5300-A-002 | PU Cover Assy (24 VDC) | 1 | | | | | 8.000 |
| 16 | MP-5300-A-001 | Battery Box Assy | 2 | | | | | 85.600 |
| 15 | MP-5200-P-001 | Lock Cover | 1 | 600-030-014 | | 16 Gauge | | 3.460 |
| 14 | MP-5200-A-001 | Lock Release Assy, 24 VDC | 1 | | | | | 6.800 |
| 13 | MP-5100-A-014 | String Pot Assembly, ANALOG | 1 | | | | | 0.700 |
| 12 | MP-5100-A-012 | Charger Assembly | 1 | | | | | 24.750 |
| 11 | MP-5100-A-003 | Master Enclosure Assembly | 1 | | | | | 26.500 |
| 10 | MP-5400-A-014 | Power Unit Assy, 24 VDC (8-2008) | 1 | | | | | 75.000 |
| 9 | MP-1100-P-003 | Sensor Cover | 1 | 600-030-014 | | 16 Gauge | | 1.000 |
| 8 | MP-1500-W-004 | Fork Weldment, Right, LONGER(22") | 1 | | | | | 115.800 |
| 7 | MP-1500-W-003 | Fork Weldment, Left, LONGER(22") | 1 | | | | | 115.830 |
| 6 | MP-0900-A-001 | Cylinder Assembly | 1 | | | | | 126.000 |
| 5 | MP-0800-P-024 | Threaded Spring Retainer | 2 | 600-090-019 | | 2" Dia x 2 1/2 Lg | | 1.170 |
| 4 | MP-1900-A-001 | Carriage Assembly (WIDER) | 1 | | | | | 300.000 |
| 3 | MP-0500-A-001 | Floor Roller Assembly | 2 | | | | | 7.840 |
| 2 | MP-0400-P-002 | Cable Hook | 2 | 600-010-027 | | 1/4 x 2" (Flat) x 13" Long | | 1.850 |
| 1 | MP-0400-A-007 | JACK ASSEMBLY | 1 | | | | | |

NOTICE OF CONFIDENTIAL INFORMATION
 INFORMATION CONTAINED HEREIN IS CONFIDENTIAL AND PROPERTY OF MOHAWK RESOURCES LTD. WHERE OBTAINED IS FURNISHED TO OTHERS IT SHALL BE USED SOLELY FOR PURPOSES OF INSPECTION, INSTALLATION, OR MAINTENANCE. THE INFORMATION SHALL NOT BE USED OR DISCLOSED BY THE RECIPIENT FOR ANY OTHER PURPOSES WHATSOEVER.

- NOTES:**
 1. REMOVE ALL SHARP CORNERS & EDGES.
 2. UNLESS OTHERWISE SPECIFIED, SURFACE FINISH TO BE 125 RMS.
 3. WELDING MEDIUM SHALL CONFORM TO AWS SPECIFICATIONS TO E-70XX ELECTRODES OR E-70TTI CODE S.3 FLUX CORE WIRE ONLY.

TOLERANCES:
 ANGULAR ± 1.5
 DIMENSIONAL ± .030
 TECHNICAL ± .030
 HOLE ± .005
 DIA ± .005

FILE NAME: MP-5400-A-015.dwg

| SCALE | 1/8 | DRAWN | dak0879 | MOHAWK RESOURCES LTD. |
|---------|------|----------|---------|--|
| CHECKED | | APPROVED | | TITLE MP-24VDC-SERIES (WIDER) Master Post Assy (22" Forks) |
| DATE | 8/08 | WEIGHT | 1837 | FROM N/A |
| | | LB. | | DRAWING NUMBER MP-5400-A-015 |

PANZITTA SALES & SERVICE
72 George Avenue
Wilkes-Barre, PA 18705
570-822-6720 800-822-6720
www.panzittasales.com

PANZITTA SALES & SERVICE
72 George Avenue
Wilkes-Barre, PA 18705
570-822-6720 800-822-6720
www.panzittasales.com

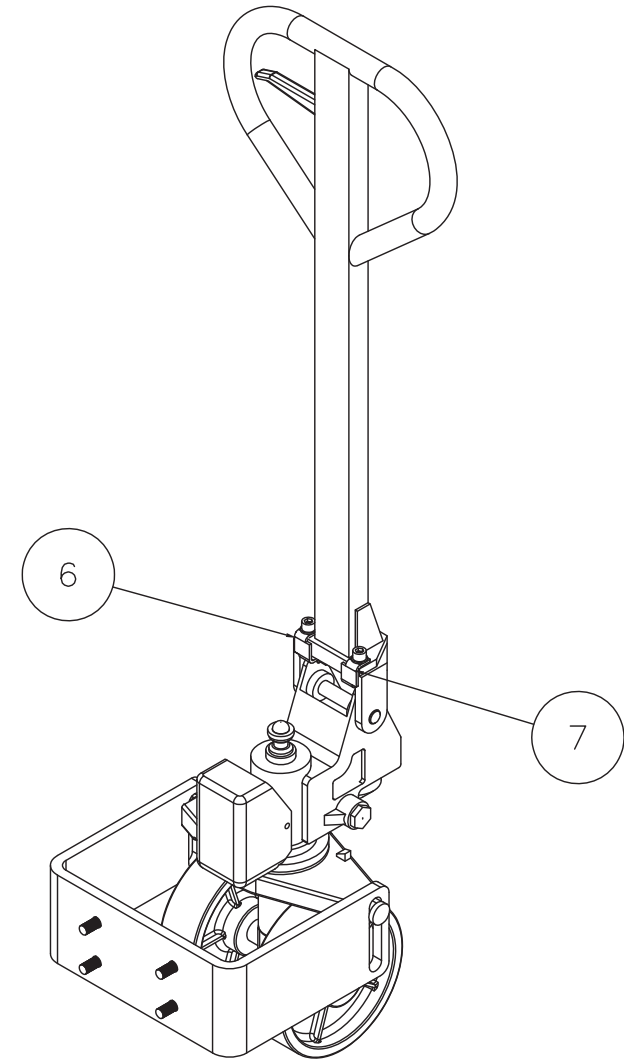
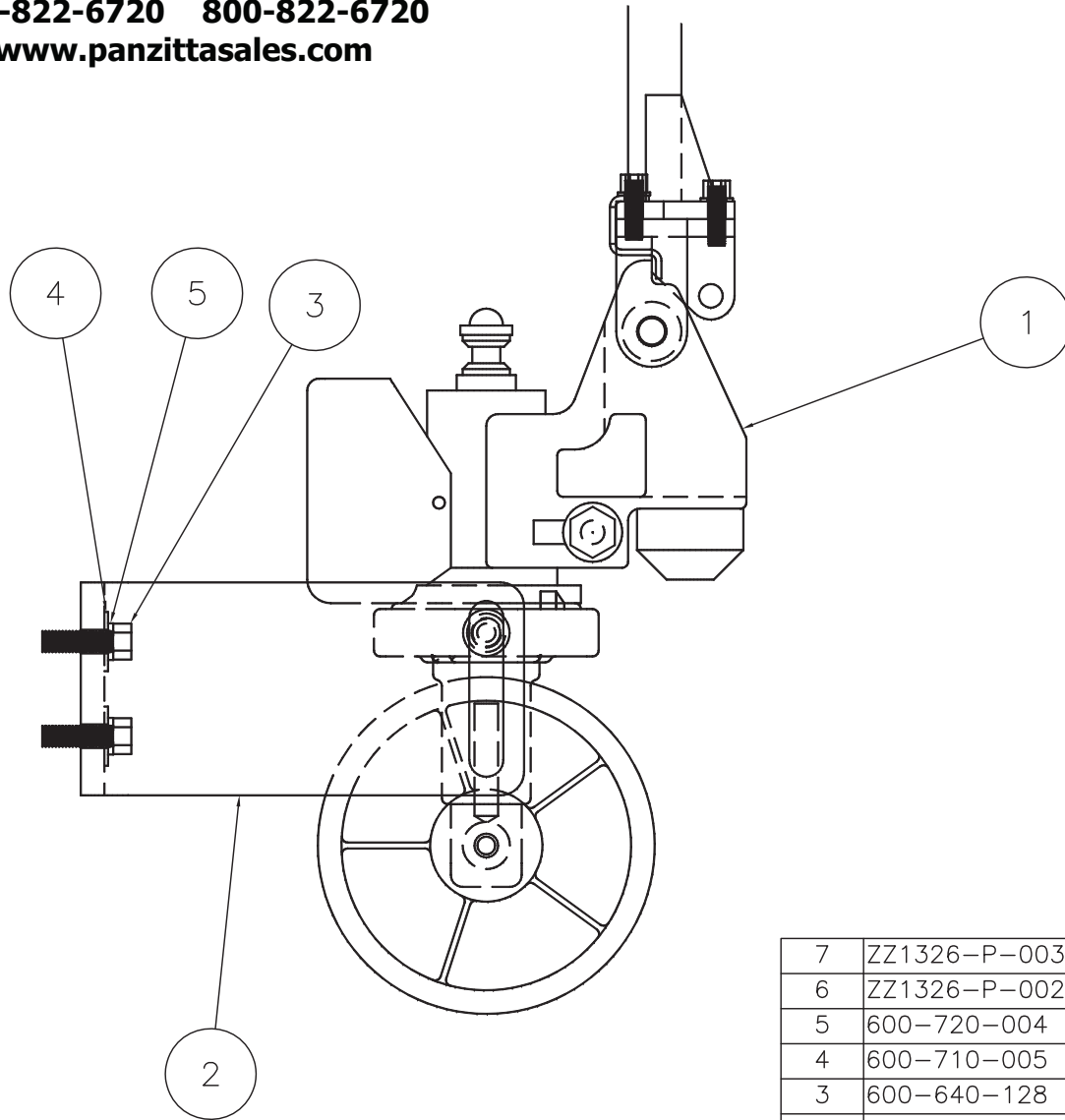

| 7 | ZZ1326-P-003 | Right Jack Stop Bracket | 1 |
|------|---------------|--|-----|
| 6 | ZZ1326-P-002 | Left Jack Stop Bracket | 1 |
| 5 | 600-720-004 | LOCK WASHER, 7/16 | 4 |
| 4 | 600-710-005 | Washer, Flat, 7/16 | 4 |
| 3 | 600-640-128 | Bolt, Hex Head, 7/16-14 NC x 1 1/2 (GR8) | 4 |
| 2 | MP-0400-P-004 | Jack Lower Support Bracket (HC Jack) | 1 |
| 1 | 601-500-011 | JACK DOLLEY | 1 |
| ITEM | NAME | DESCRIPTION | QTY |

C-SIZE

NOTICE OF CONFIDENTIAL INFORMATION

INFORMATION CONTAINED HEREIN IS CONFIDENTIAL AND PROPERTY OF MOHAWK RESOURCES LTD., WHERE DRAWING IS FURNISHED TO OTHERS IT SHALL BE USED SOLELY FOR PURPOSES OF INSPECTION, INSTALLATION, OR MAINTENANCE. THE INFORMATION SHALL NOT BE USED OR DISCLOSED BY THE RECIPIENT FOR ANY OTHER PURPOSES WHATSOEVER.

NOTES:

1. REMOVE ALL SHARP CORNERS & EDGES.
2. UNLESS OTHERWISE SPECIFIED, SURFACE FINISH TO BE 125 RMS.
3. WELDING MEDIUM SHALL CONFORM TO AWS SPECIFICATIONS TO E-70XX ELECTRODES OR E-70TI CODE 5.3 FLUX CORE WIRE ONLY.

TOLERANCES:
 ANGULAR ± 1°
 FRACTIONAL ± .030
 DECIMAL:
 0.XX ± .030
 0.XXX ± .005

FILE NAME
 MP-0400-A-007

NEXT ASSEMBLY

SCALE
 1/2

CHECKED

DATE
 07/11

DRAWN
 G.GORE

APPROVED

WEIGHT
 47.5 LB.

MOHAWK RESOURCES LTD.

TITLE *Mobile Post Lift
 Jack Assembly*

FROM

DRAWING NUMBER
 MP-0400-A-007



| # | DESCRIPTION | DATE | APPROVED |
|---|------------------------|------------|----------|
| A | ITEM 1 WAS 601-300-094 | 08/15/2008 | dak0879 |

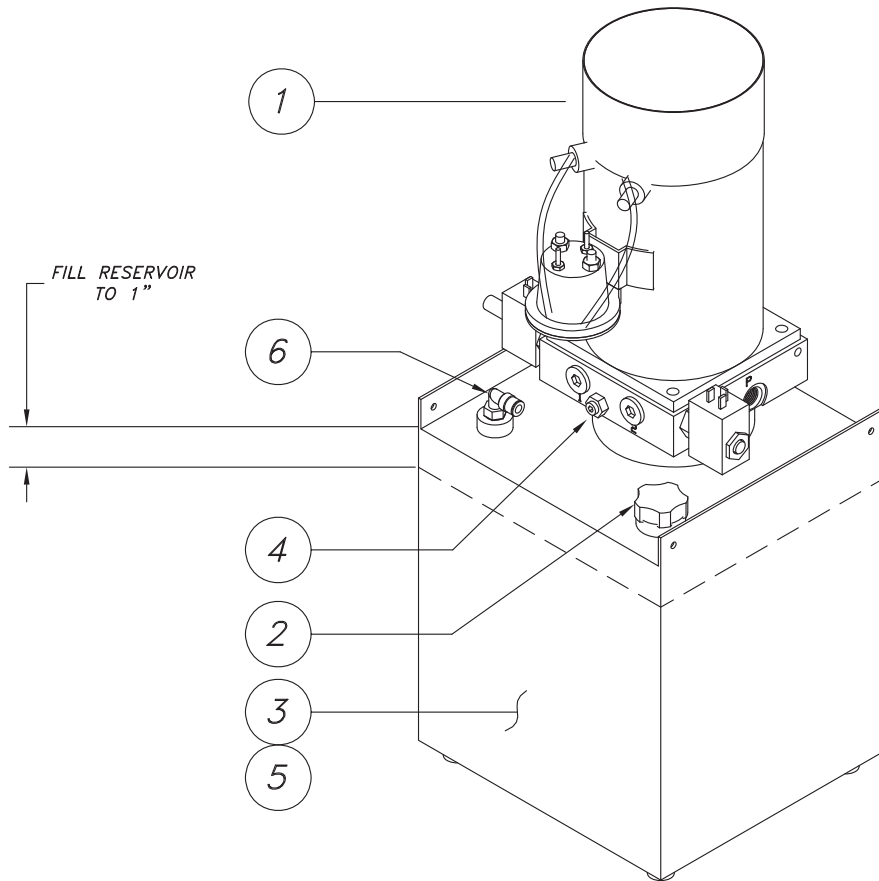

PANZITTA SALES & SERVICE
72 George Avenue
Wilkes-Barre, PA 18705
570-822-6720 800-822-6720
www.panzittasales.com



| 6 | 601-520-003 | 90 Deg Swivel, 1/4 NPT to 1/4 Tube | 1 |
|------|-------------|---------------------------------------|-----|
| 5 | 601-610-007 | Hydraulic Fluid Additive 0.02 Bottles | 1 |
| 4 | 601-610-006 | Tamper-Proof Sealant 0.05 Tubes | 1 |
| 3 | 601-610-001 | Hydraulic Fluid, 3.25 Gallons | 1 |
| 2 | 601-310-005 | Breather Cap | 1 |
| 1 | 601-300-095 | Power Unit, 24 VDC Mobile Post | 1 |
| ITEM | NAME | DESCRIPTION | QTY |

Parts List

C-SIZE

NOTICE OF CONFIDENTIAL INFORMATION

INFORMATION CONTAINED HEREIN IS CONFIDENTIAL AND PROPERTY OF MOHAWK RESOURCES LTD., WHERE DRAWING IS FURNISHED TO OTHERS IT SHALL BE USED SOLELY FOR PURPOSES OF INSPECTION, INSTALLATION, OR MAINTENANCE. THE INFORMATION SHALL NOT BE USED OR DISCLOSED BY THE RECIPIENT FOR ANY OTHER PURPOSES WHATSOEVER.

NOTES:

- REMOVE ALL SHARP CORNERS & EDGES.
- UNLESS OTHERWISE SPECIFIED, SURFACE FINISH TO BE 125 RMS.
- WELDING MEDIUM SHALL CONFORM TO AWS SPECIFICATIONS TO E-70XX ELECTRODES OR E-70TI CODE 5.3 FLUX CORE WIRE ONLY.

TOLERANCES:
 ANGULAR ± 1°
 FRACTIONAL ± .030
 DECIMAL:
 0.XX ± .030
 0.XXX ± .005

FILE NAME
 MP-5400-A-014

MP-5400-A-001 & 004

NEXT ASSEMBLY

SCALE
 3/8

CHECKED

DATE
 7/08

DRAWN
 DM

APPROVED

WEIGHT
 75 LB.

MOHAWK RESOURCES LTD.

TITLE *Mobile Post (8-2008)*
P.U. Assy, 24 VDC

FROM

DRAWING NUMBER
 MP-5400-A-014



PANZITTA SALES & SERVICE
72 George Avenue
Wilkes-Barre, PA 18705
570-822-6720 800-822-6720
www.panzittasales.com

| # | DESCRIPTION | DATE | APPROVED |
|---|------------------|------------|----------|
| A | 1) VIEWS UPDATED | 08/30/2005 | dak0879 |
| | 2) WT WAS 7.92 | | |

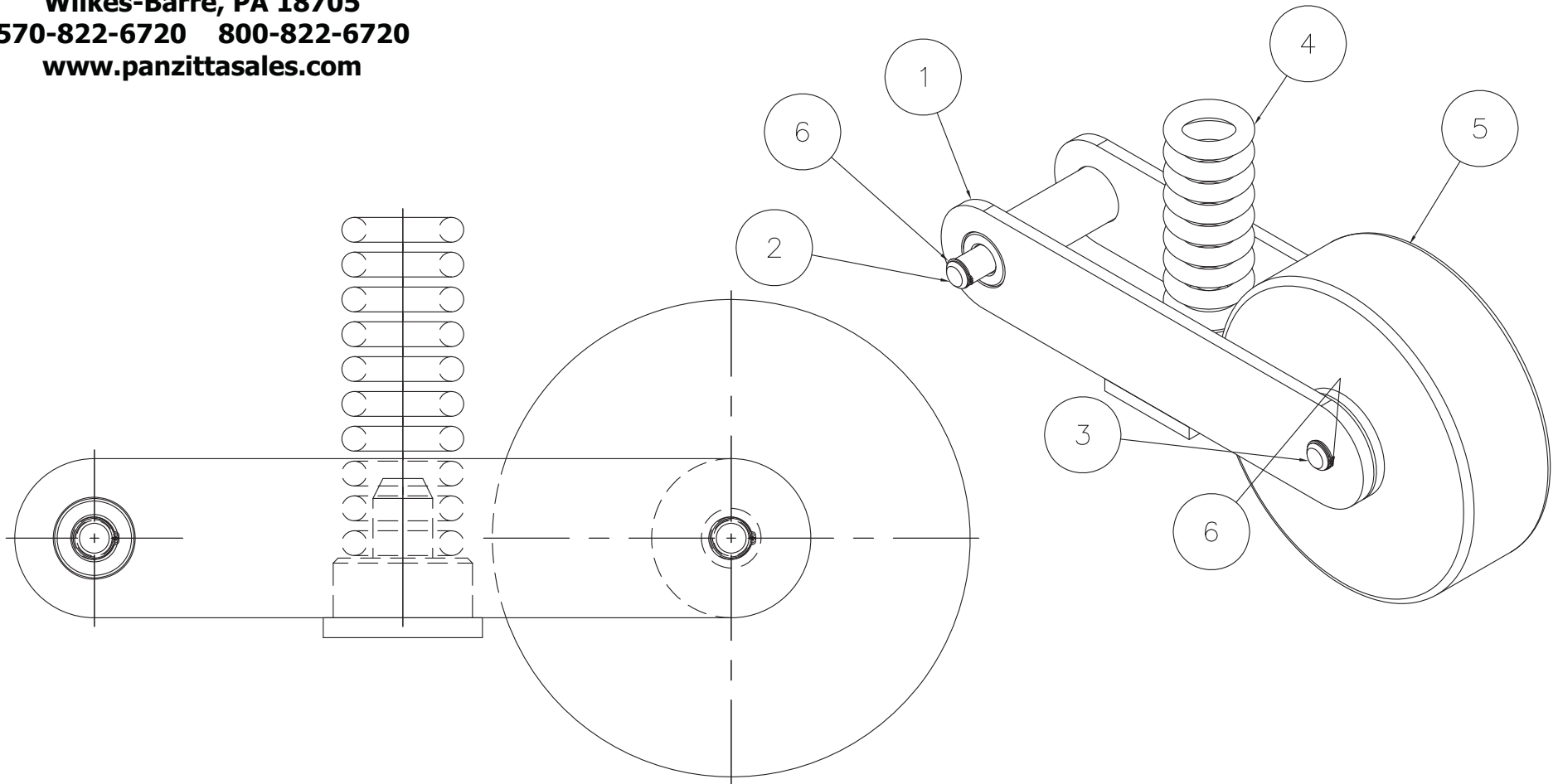

| 6 | 600-870-003 | Snap Ring, External, 1/2 | 4 |
|------|---------------|--------------------------------------|-----|
| 5 | 600-920-018 | Wheel, 6" Dia x 1/2 ID x 2 3/16 Hub | 1 |
| 4 | 600-840-025 | Spring, 4.25 Lg x 1.531 OD x .907 ID | 1 |
| 3 | MP-0500-P-006 | Roller Axle Pin | 1 |
| 2 | MP-0500-P-005 | Pivot Pin | 1 |
| 1 | MP-0500-W-001 | Roller Pivot Weldment | 1 |
| ITEM | NAME | DESCRIPTION | QTY |

Parts List

C-SIZE

NOTICE OF CONFIDENTIAL INFORMATION

INFORMATION CONTAINED HEREIN IS CONFIDENTIAL AND PROPERTY OF MOHAWK RESOURCES LTD., WHERE DRAWING IS FURNISHED TO OTHERS IT SHALL BE USED SOLELY FOR PURPOSES OF INSPECTION, INSTALLATION, OR MAINTENANCE. THE INFORMATION SHALL NOT BE USED OR DISCLOSED BY THE RECIPIENT FOR ANY OTHER PURPOSES WHATSOEVER.

NOTES:

1. REMOVE ALL SHARP CORNERS & EDGES.
2. UNLESS OTHERWISE SPECIFIED, SURFACE FINISH TO BE 125 RMS.
3. WELDING MEDIUM SHALL CONFORM TO AWS SPECIFICATIONS TO E-70XX ELECTRODES OR E-70TI CODE 5.3 FLUX CORE WIRE ONLY.

TOLERANCES:

| | |
|------------|--------|
| ANGULAR | ± 1° |
| FRACTIONAL | ± .030 |
| DECIMAL: | |
| 0.XX | ± .030 |
| 0.XXX | ± .005 |

FILE NAME
MP-0500-A-001.dwg

MP-

NEXT ASSEMBLY

SCALE
1"0"=1'0"

CHECKED

DATE
07/26/2004

DRAWN
rww7089

APPROVED

DATE
07/26/2004

WEIGHT
7.84 LB.

MOHAWK RESOURCES LTD.

TITLE *Mobile Post Lift
Floor Roller Assembly*

FROM
N/A

DRAWING NUMBER
MP-0500-A-001



| # | DESCRIPTION | DATE | APPROVED |
|---|--|------------|----------|
| B | 1) 600-600-008, 600-680-013, & MP-5200-P-004 ADDED | 04/27/2007 | dak0879 |
| | 2) WAS QTY 3 3) WAS QTY 2 | | |
| | 4) WAS QTY 1 | | |

| # | DESCRIPTION | DATE | APPROVED |
|---|-------------------------|------------|----------|
| A | ITEM 18 WAS 601-160-200 | 03/26/2007 | dak0879 |

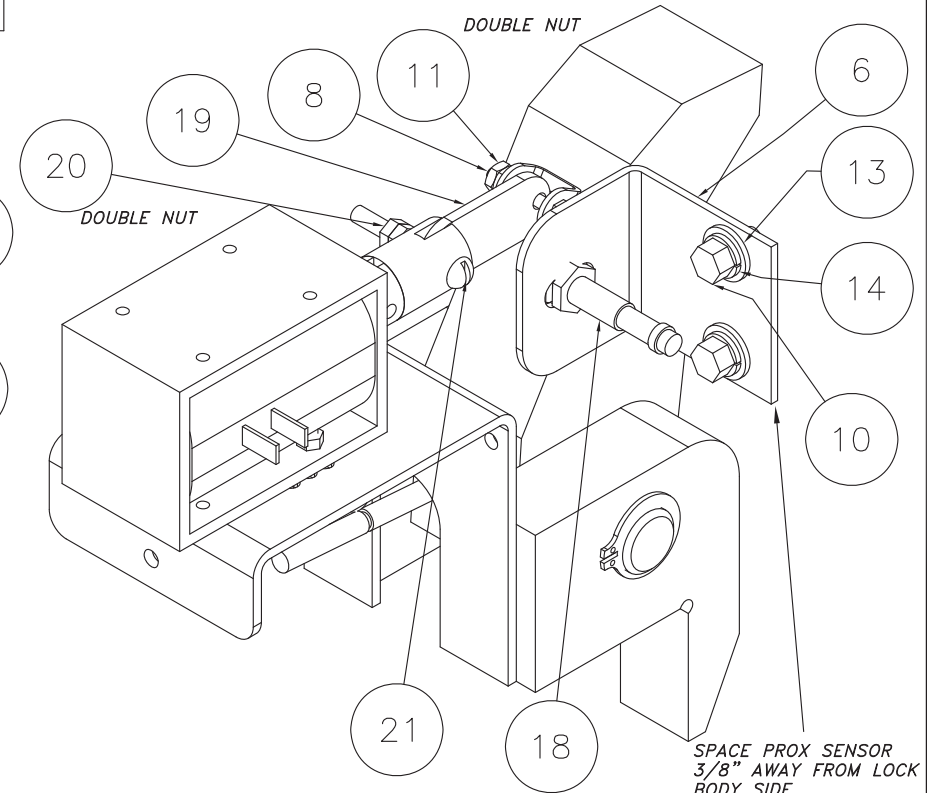
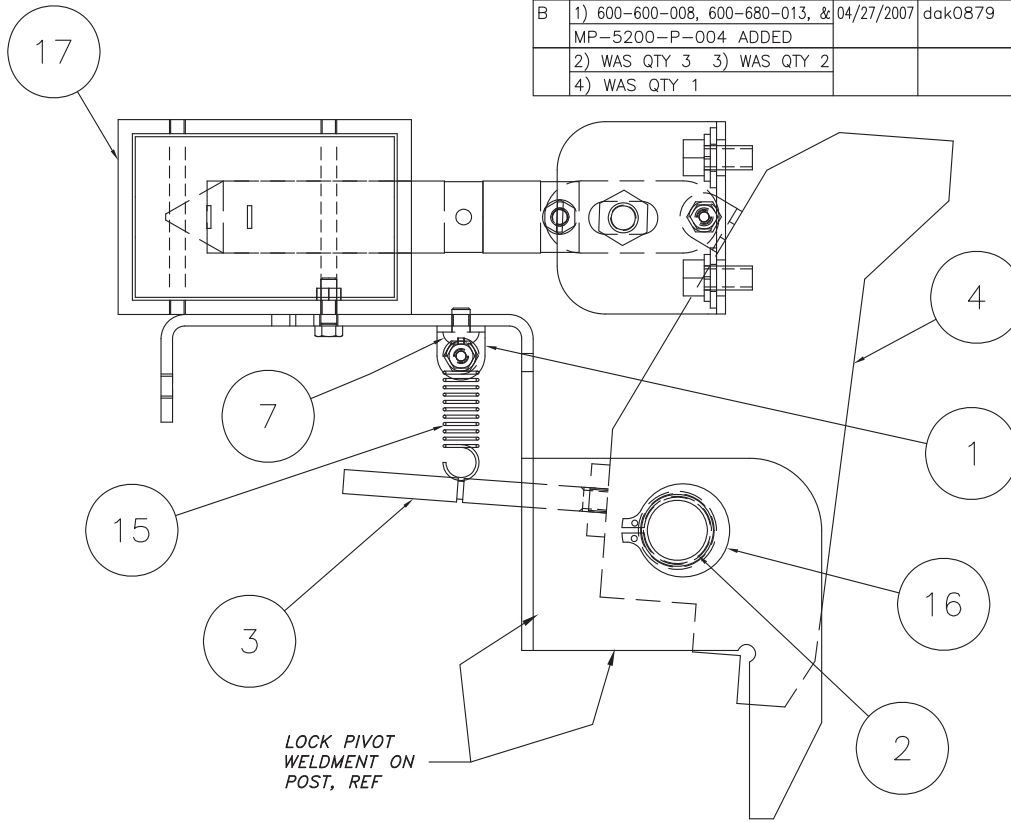

| ITEM | NAME | DESCRIPTION | QTY |
|------|---------------|---|-----|
| 21 | 600-600-008 | Screw, Slotted Round Head, #10-32 NF x 1 1/2 | 1 |
| 20 | 600-680-013 | Nut, Plain, #10-32 NF | 2 |
| 19 | MP-5200-P-004 | Lock Flat | 1 |
| 18 | 601-160-213 | Inductive Proximity Switch, 10-30 VDC | 1 |
| 17 | 601-160-199 | Lock Solenoid, 24 VDC, 1" Stroke, 100% Duty | 1 |
| 16 | 600-870-005 | Snap Ring, 0.693 ID | 2 |
| 15 | 600-840-026 | Spring, Extension, 1" Lg | 1 |
| 14 | 600-720-007 | Washer, Lock, 1/4 | 2 |
| 13 | 600-710-004 | Washer, Flat, 1/4 | 2 |
| 12 | 600-680-028 | Nut, Plain, #8-32 NC | 2 |
| 11 | 600-680-023 | Plain Nut, #6-32NC | 4 |
| 10 | 600-640-042 | Bolt, Hex Head, 1/4-20 NC x 1/2 (GR5) | 2 |
| 9 | 600-600-029 | Hex Machine Screw, #8-32NC x 1/2 Lg | 2 |
| 8 | 600-600-019 | Hex Head Machine Screw, #6-32NC x 1" Long | 2 |
| 7 | 600-600-013 | Screw, #10-32 x 1/4", Slotted Round Head, Machine | 1 |
| 6 | MP-5200-P-003 | Prox Mounting Bracket | 1 |
| 5 | MP-5200-P-002 | Lock Solenoid Mounting Bracket | 1 |
| 4 | MP-0600-W-002 | Lock Weldment | 1 |
| 3 | MP-0600-P-006 | Lock Release Handle | 1 |
| 2 | MP-0600-P-004 | Lock Pivot Pin | 1 |
| 1 | MP-0600-P-003 | Spring Clip | 1 |

PANZITTA SALES & SERVICE
72 George Avenue
Wilkes-Barre, PA 18705
570-822-6720 800-822-6720
www.panzittasales.com

C-SIZE

NOTICE OF CONFIDENTIAL INFORMATION

INFORMATION CONTAINED HEREIN IS CONFIDENTIAL AND PROPERTY OF MOHAWK RESOURCES LTD., WHERE DRAWING IS FURNISHED TO OTHERS IT SHALL BE USED SOLELY FOR PURPOSES OF INSPECTION, INSTALLATION, OR MAINTENANCE. THE INFORMATION SHALL NOT BE USED OR DISCLOSED BY THE RECIPIENT FOR ANY OTHER PURPOSES WHATSOEVER.

NOTES:

- REMOVE ALL SHARP CORNERS & EDGES.
- UNLESS OTHERWISE SPECIFIED, SURFACE FINISH TO BE 125 RMS.
- WELDING MEDIUM SHALL CONFORM TO AWS SPECIFICATIONS TO E-70XX ELECTRODES OR E-70TI CODE 5.3 FLUX CORE WIRE ONLY.

| TOLERANCES: | |
|-------------|--------|
| ANGULAR | ± 1° |
| FRACTIONAL | ± .030 |
| DECIMAL | ± .030 |
| 0.XX | ± .030 |
| 0.XXX | ± .005 |

FILE NAME
MP-5200-A-001.dwg

| | |
|------------------|-------------------|
| SCALE 1"=1'0" | DRAWN rwv7089 |
| CHECKED | APPROVED |
| DATE 12/8/06 | WEIGHT 6.8 LB. |
| NEXT ASSEMBLY | FROM n/a |

| | |
|---|---------------------------------|
| TITLE MP-24VDC-SERIES Lock Assembly, 24 VDC | DRAWING NUMBER MP-5200-A-001 |
|---|---------------------------------|

| | |
|--|---------------------------------|
| MOHAWK RESOURCES LTD. | |
| TITLE MP-24VDC-SERIES Lock Assembly, 24 VDC | |
| FROM n/a | DRAWING NUMBER MP-5200-A-001 |



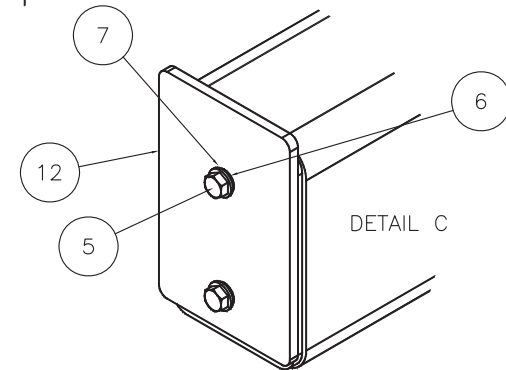
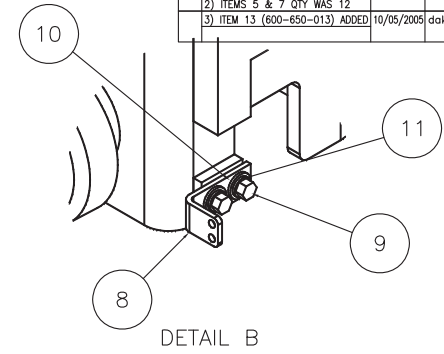
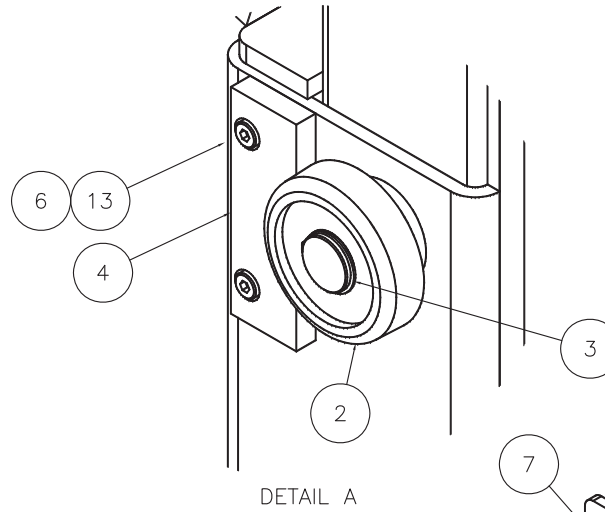
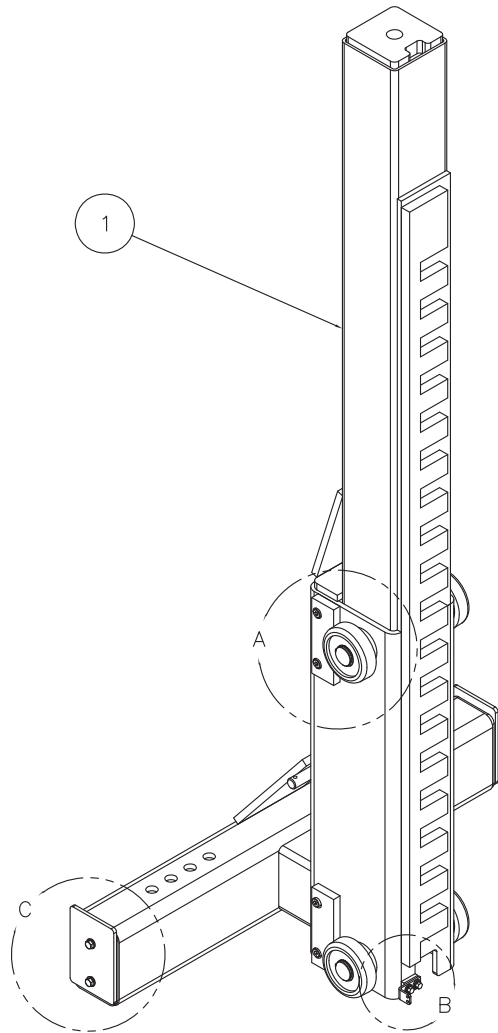

| # | DESCRIPTION | DATE | APPROVED |
|---|-------------------------|------------|----------|
| D | 1) ITEM 1 VIEW UPDATED | 10/26/2005 | dak0879 |
| | 2) ITEM 12 VIEW UPDATED | | |

| # | DESCRIPTION | DATE | APPROVED |
|---|--|------------|----------|
| A | 1) ITEM 4 THICKNESS WAS 9/16 | 06/28/2005 | dak0879 |
| | 2) ITEMS 5, 6, 7, 9, 10, 11 QTY WAS 1 (TYPO ERROR) | 06/28/2005 | dak0879 |
| | 3) ITEM 5 WAS 600-640-001 | | |
| B | View of Item 1 Changed | 08/25/2005 | rwv7089 |
| C | 1) ITEM 2 WAS 600-860-018 | 10/05/2005 | dak0879 |
| | 2) ITEMS 5 & 7 QTY WAS 12 | | |
| | 3) ITEM 13 (600-650-013) ADDED | 10/05/2005 | dak0879 |

| | | | | |
|----------------|----|---------------|---|----|
| $\triangle C3$ | 13 | 600-650-013 | Socket Cap Screw, 5/16-18 NC x 3/4 Lg | 8 |
| | 12 | MP-0700-P-016 | Tube End Stop | 2 |
| | 11 | 600-720-007 | Washer, Lock, 1/4 | 2 |
| | 10 | 600-710-004 | Washer, Flat, 1/4 | 2 |
| | 9 | 600-640-042 | Bolt, Hex Head, 1/4-20 NC x 1/2 (GR5) | 2 |
| | 8 | MP-0700-P-015 | Cable Support Angle | 1 |
| $\triangle C2$ | 7 | 600-710-003 | Washer, Flat, 5/16 | 4 |
| | 6 | 600-720-002 | Washer, Lock, 5/16 | 12 |
| $\triangle C2$ | 5 | 600-640-017 | Bolt, Hex Head, 5/16-18 NC x 1" lg (Gr 5) | 4 |
| | 4 | MP-0700-P-012 | Slide Block, UHMW | 4 |
| | 3 | 600-870-001 | Snap Ring, 1 3/8 Shaft | 4 |
| $\triangle C1$ | 2 | MP-0700-A-002 | Carriage Roller Assembly | 4 |
| | 1 | MP-0700-W-001 | Carriage Weldment | 1 |

| ITEM | NAME | DESCRIPTION | QTY |
|------------|------|-------------|-----|
| Parts List | | | |

NOTICE OF CONFIDENTIAL INFORMATION

INFORMATION CONTAINED HEREIN IS CONFIDENTIAL AND PROPERTY OF MOHAWK RESOURCES LTD., WHERE DRAWING IS FURNISHED TO OTHERS IT SHALL BE USED SOLELY FOR PURPOSES OF INSPECTION, INSTALLATION, OR MAINTENANCE. THE INFORMATION SHALL NOT BE USED OR DISCLOSED BY THE RECIPIENT FOR ANY OTHER PURPOSES WHATSOEVER.

NOTES:
 1. REMOVE ALL SHARP CORNERS & EDGES.
 2. UNLESS OTHERWISE SPECIFIED, SURFACE FINISH TO BE 125 RMS.
 3. WELDING MEDIUM SHALL CONFORM TO AWS SPECIFICATIONS TO E-70XX ELECTRODES OR E-70TI CODE S.3 FLUX CORE WIRE ONLY.

TOLERANCES:
 ANGULAR ± 1°
 FRACTIONAL ± .030
 DECIMAL ± .030
 0.XXX ± .005

FILE NAME
 MP-0700-A-001.dwg

SCALE
 1"0"=1'0"

DRAWN
 rwv7089

CHECKED
 APPROVED

DATE
 07/21/2004

WEIGHT
 290 LB.

FROM
 n/a

DRAWING NUMBER
 MP-0700-A-001

MOHAWK RESOURCES LTD.

TITLE
 Mobile Post Lift Carriage Assembly

PANZITTA SALES & SERVICE
72 George Avenue
Wilkes-Barre, PA 18705
570-822-6720 800-822-6720
www.panzittasales.com

| # | DESCRIPTION | DATE | APPROVED |
|---|------------------------------------|------------|----------|
| A | ITEM 5 WMS 600-650-013 (3/4" LONG) | 05/12/2008 | dak0879 |

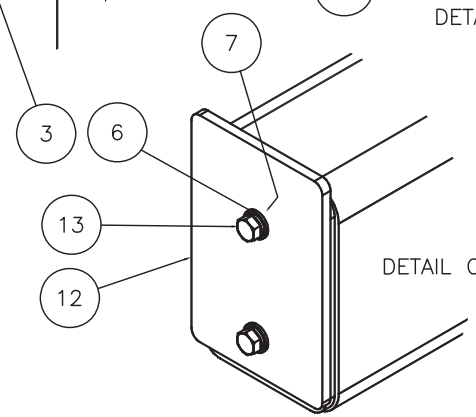
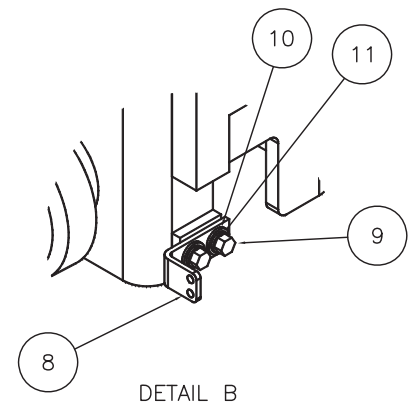
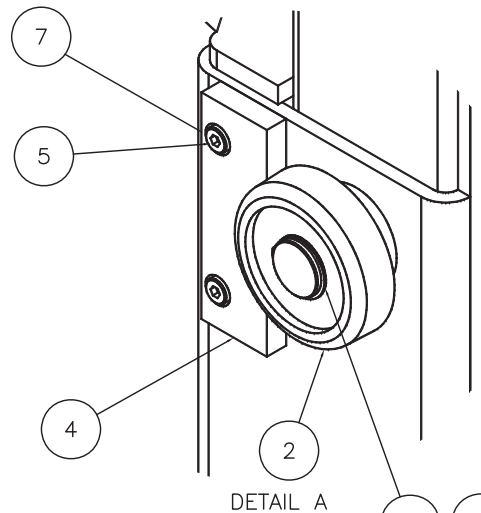
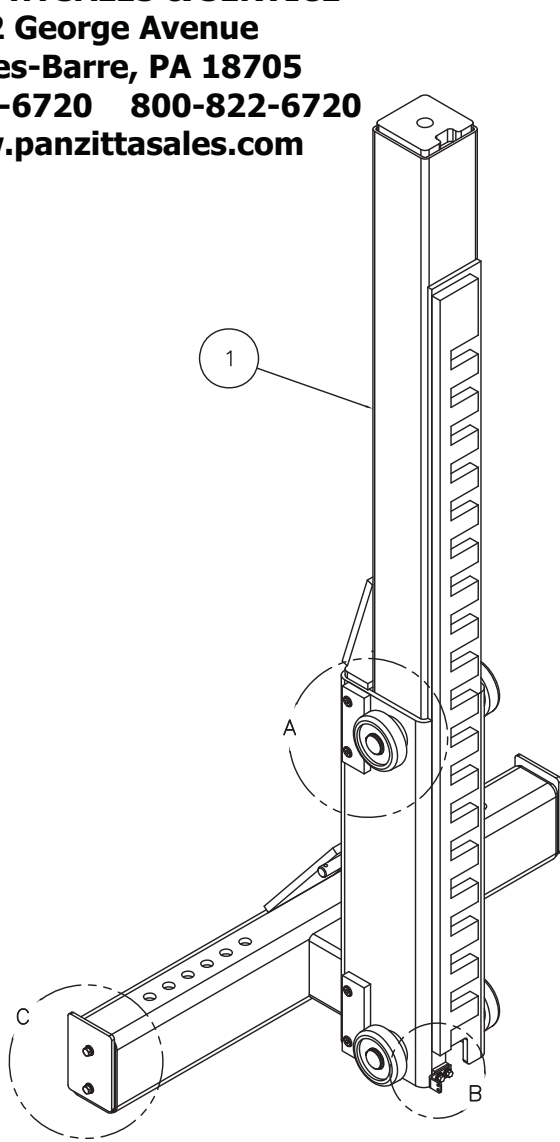

WIDER

| | | | |
|------|---------------|---|-----|
| 13 | 600-640-017 | Bolt, Hex Head, 5/16-18 NC x 1 1/4" lg (Gr 5) | 4 |
| 12 | MP-0700-P-016 | Tube End Stop | 2 |
| 11 | 600-720-007 | Washer, Lock, 1/4 | 2 |
| 10 | 600-710-004 | Washer, Flat, 1/4 | 2 |
| 9 | 600-640-042 | Bolt, Hex Head, 1/4-20 NC x 1/2 (GR5) | 2 |
| 8 | MP-0700-P-015 | Cable Support Angle | 1 |
| 7 | 600-710-003 | Washer, Flat, 5/16 | 4 |
| 6 | 600-720-002 | Washer, Lock, 5/16 | 12 |
| 5 | 600-650-016 | Socket Cap Screw, 5/16-18 NC x 1" Lg | 8 |
| 4 | MP-0700-P-012 | Slide Block, UHMW | 4 |
| 3 | 600-870-001 | Snap Ring, 1 3/8 Shaft | 4 |
| 2 | MP-0700-A-002 | Carriage Roller Assembly | 4 |
| 1 | MP-1900-W-001 | Carriage Weldment (WIDER) | 1 |
| ITEM | NAME | DESCRIPTION | QTY |

NOTICE OF CONFIDENTIAL INFORMATION
 INFORMATION CONTAINED HEREIN IS CONFIDENTIAL AND PROPERTY OF MOHAWK RESOURCES LTD. THESE DRAWINGS IS FURNISHED TO OTHERS IT SHALL BE USED SOLELY FOR PURPOSES OF INSPECTION, INSTALLATION, OR MAINTENANCE. THE INFORMATION SHALL NOT BE USED OR DISCLOSED BY THE RECIPIENT FOR ANY OTHER PURPOSES WHATSOEVER.

NOTES:
 1. REMOVE ALL SHARP CORNERS & EDGES.
 2. UNLESS OTHERWISE SPECIFIED, SURFACE FINISH TO BE 125 RMS.
 3. WELDING MEDIUM SHALL CONFORM TO AWS SPECIFICATIONS TO E-70XX ELECTRODES OR E-70TTI CODE S3 FLUX CORE WIRE ONLY.

TOLERANCES:
 ANGULAR ± 1°
 FINISH DIMENSIONAL ± .030
 DECIMAL 0.001
 0.005
 0.005
 0.005

| SCALE | 1/4 | DRAWN | dak | MOHAWK RESOURCES LTD. |
|-----------|-------------------|---------------|---------|---|
| CHECKED | | APPROVED | | TITLE <i>Mobile Post Lift Carriage Assembly</i> |
| DATE | 7/7/05 | WEIGHT | 300 LB. | FROM |
| FILE NAME | MP-1900-A-001.dwg | NEXT ASSEMBLY | | DRAWING NUMBER MP-1900-A-001 |

D-SIZE

| # | DESCRIPTION | DATE | APPROVED |
|---|-----------------------------|------------|----------|
| A | Item 12 was 601-520-003 | 03/01/2005 | rwv7089 |
| | Item 10 was at 45 Degrees | | |
| B | Items 13, 14, 15 & 16 Added | 07/08/2005 | rwv7089 |

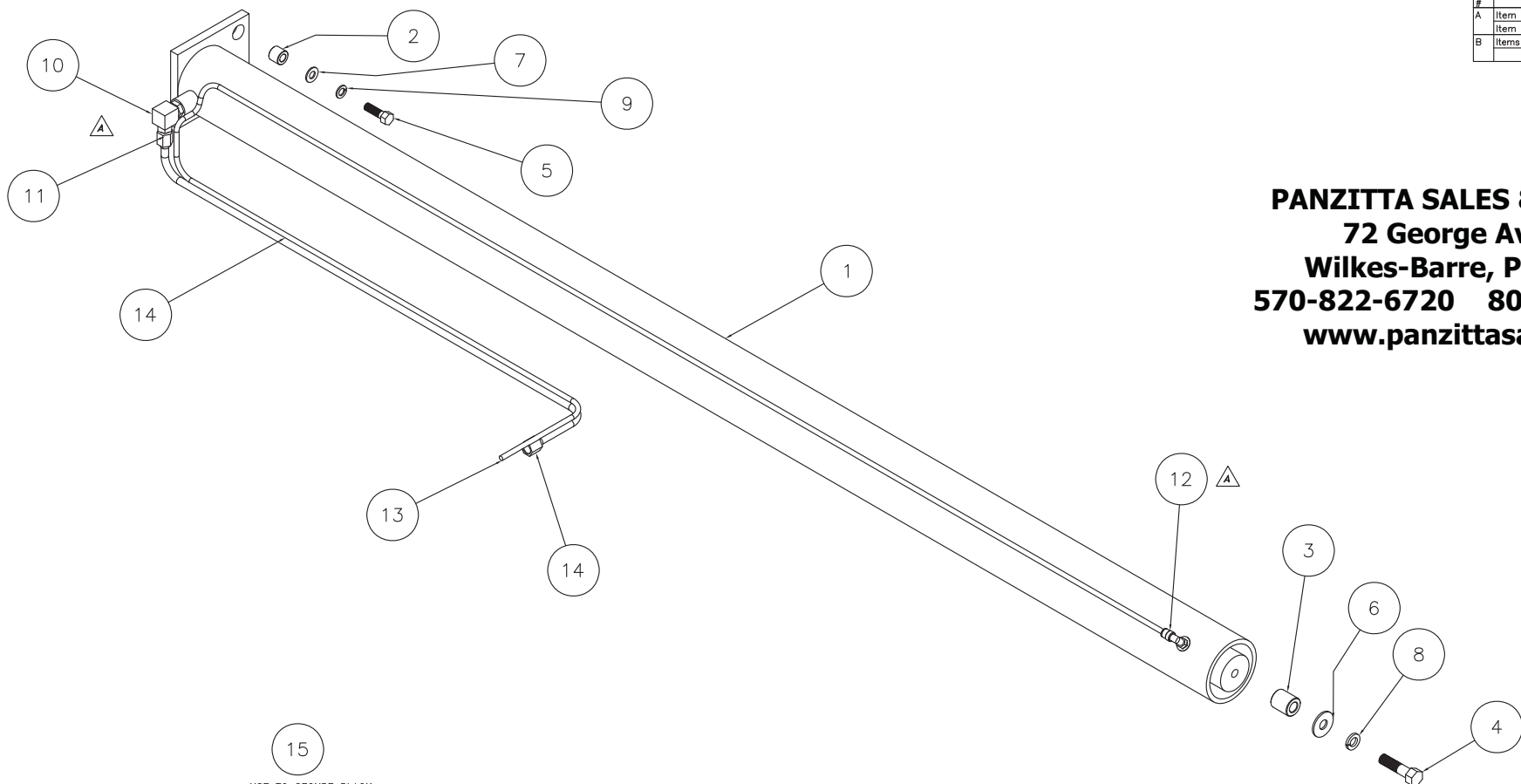

PANZITTA SALES & SERVICE
72 George Avenue
Wilkes-Barre, PA 18705
570-822-6720 800-822-6720
www.panzittasales.com

15
 USE TO SECURE BLACK
 TUBING TO CYLINDER BARREL
 (NOT SHOWN)

16
 USE TO SECURE BLACK
 TUBING TO HYDRAULIC LINE
 (NOT SHOWN)

| ITEM | NAME | DESCRIPTION | QTY |
|------|---------------|---|-----|
| 16 | 601-600-029 | Pull Tie, Black, 8 1/2" Long | 6 |
| 15 | 601-600-021 | Pull Tie, Black, 15" Long | 4 |
| 14 | MP-1200-A-002 | Tube Assembly | 1 |
| 13 | MP-0900-P-401 | Tubing, Black Plastic, 1/4" x 115" Long | 1 |
| 12 | 601-520-002 | 90° Elbow Swiv, 1/8 NPT To 1/4 Tube | 1 |
| 11 | 601-420-019 | Straight, #6 ORB to #6 JIC | 1 |
| 10 | 601-410-073 | Velocity Fuse, 5 GPM | 1 |
| 9 | 600-720-011 | Washer, Lock, 3/8 | 2 |
| 8 | 600-720-005 | Washer, Lock, 1/2 | 1 |
| 7 | 600-710-009 | Washer, Flat, 3/8 | 2 |
| 6 | 600-710-008 | Washer, Flat, 1/2 | 1 |
| 5 | 600-640-095 | Bolt, Hex Head, 3/8-16 NC x 1 1/4 (GRB) | 2 |
| 4 | 600-640-030 | Bolt, Hex Head, 1/2-13 NC x 2" (GRB) | 1 |
| 3 | MP-0900-P-003 | Cylinder Rod Bushing | 1 |
| 2 | MP-0900-P-002 | Cylinder Base Bushing | 2 |
| 1 | MP-0900-P-001 | Cylinder Assembly, Purchased | 1 |

NOTICE OF CONFIDENTIAL INFORMATION

INFORMATION CONTAINED HEREIN IS CONFIDENTIAL AND PROPERTY OF MOHAWK RESOURCES LTD.. WHERE DRAWING IS FURNISHED TO OTHERS IT SHALL BE USED SOLELY FOR PURPOSES OF INSPECTION, INSTALLATION, OR MAINTENANCE. THE INFORMATION SHALL NOT BE USED OR DISCLOSED BY THE RECIPIENT FOR ANY OTHER PURPOSES WHATSOEVER.

NOTES:
 1. REMOVE ALL SHARP CORNERS & EDGES.
 2. UNLESS OTHERWISE SPECIFIED, SURFACE FINISH TO BE 125 RMS.
 3. WELDING MEDIUM SHALL CONFORM TO AWS SPECIFICATIONS TO E-70XX ELECTRODES OR E-70T1 CODE S.3 FLUX CORE WIRE ONLY.

TOLERANCES:
 ANGULAR ± 1°
 FRACTIONAL ± .030
 DECIMAL 0.XXX ± .005
 0.XXX ± .005
 FILE NAME
 MP-0900-A-001.dwg

MP-0400-A-002
 MP-0400-A-001
 NEXT ASSEMBLY

SCALE 1"=1'0"
 DRAWN rwv7089
 CHECKED APPROVED
 DATE 09/08/2004
 WEIGHT 126 LB.
 FROM n/a
 DRAWING NUMBER MP-0900-A-001

D-SIZE

| # | DESCRIPTION | DATE | APPROVED |
|---|--|------------|----------|
| A | View of Bottom Pigtails Revised | 06/18/2008 | rwv7089 |
| B | Item 3 was MP-5100-A-007 Item 4 was MP-5100-A-008 | 06/15/2008 | rwv7089 |

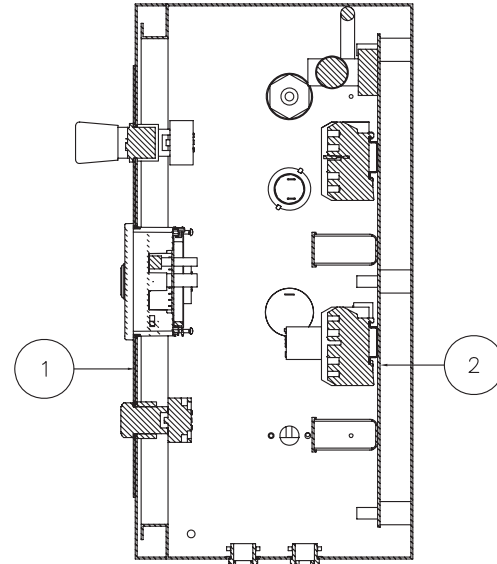
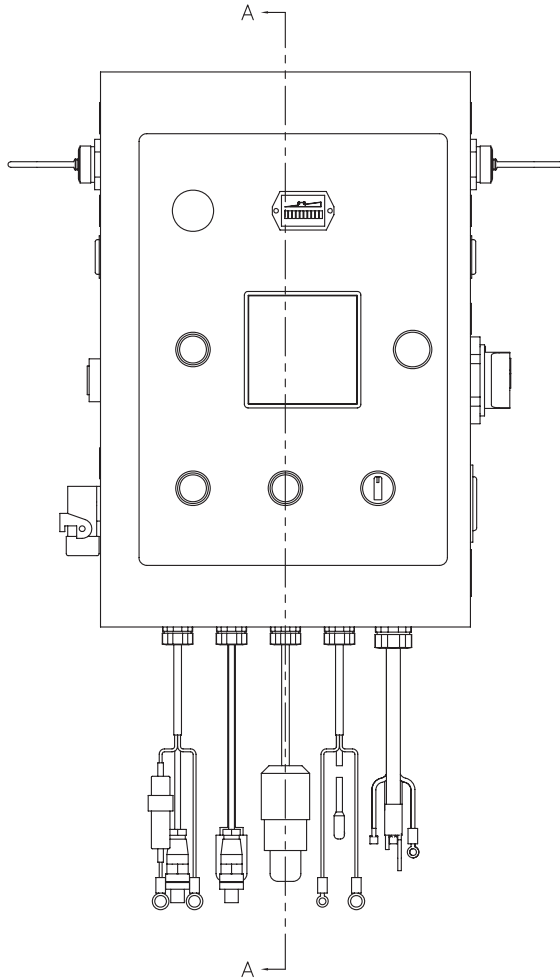

SECTION A-A

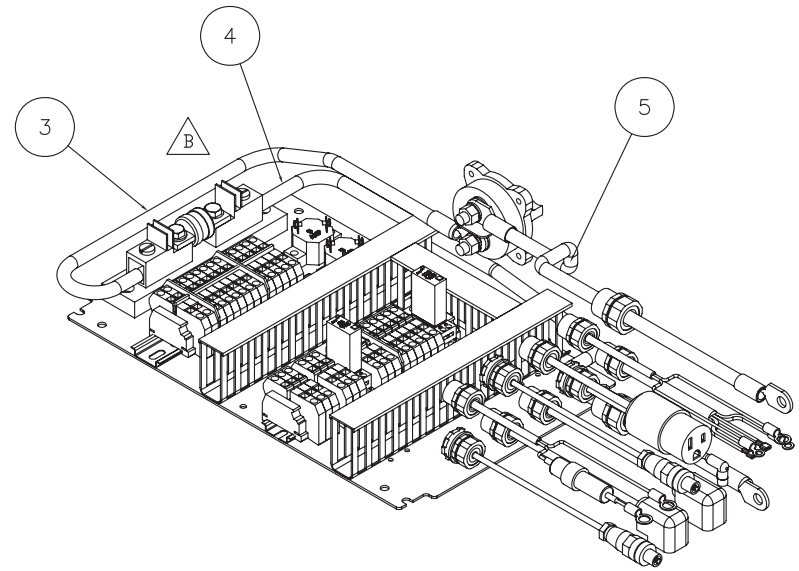

| 5 | MP-5100-A-009 | Cable Assy, 48" Lg, Red | 1 |
|------|---------------|---------------------------|-----|
| 4 | MP-5100-A-023 | Cable Assy, 36" Lg, Red | 1 |
| 3 | MP-5100-A-024 | Cable Assy, 18" Lg, Red | 1 |
| 2 | MP-5100-A-004 | Master Panel Assembly | 1 |
| 1 | MP-5100-A-003 | Master Enclosure Assembly | 1 |
| ITEM | NAME | DESCRIPTION | QTY |

Parts List

NOTICE OF CONFIDENTIAL INFORMATION

INFORMATION CONTAINED HEREIN IS CONFIDENTIAL AND PROPERTY OF MOHAWK RESOURCES LTD. WHERE DRAWING IS FURNISHED TO OTHERS IT SHALL BE USED SOLELY FOR PURPOSES OF INSPECTION, INSTALLATION, OR MAINTENANCE. THE INFORMATION SHALL NOT BE USED OR DISCLOSED BY THE RECIPIENT FOR ANY OTHER PURPOSES WHATSOEVER.

NOTES:
 1. REMOVE ALL SHARP CORNERS & EDGES.
 2. UNLESS OTHERWISE SPECIFIED, SURFACE FINISH TO BE 125 RMS.
 3. WELDING MEDIUM SHALL CONFORM TO AWS SPECIFICATIONS TO E-70XX ELECTRODES OR E-70TTI CODE 3.3 FLUX CORE WIRE ONLY.

TOLERANCES:
 ANGULAR ± 1°
 DECIMAL ± .030
 DECIMAL 0.XXX ± .005

FILE NAME: MP-5100-A-001
 NEXT ASSEMBLY

| | | | |
|------------------|------------------|---|---------------------------------|
| SCALE 1/2 | DRAWN rwv7089 | MOHAWK RESOURCES LTD. | |
| CHECKED | APPROVED | TITLE MP-24VDC-SERIES Master Box Assy | |
| DATE 11/30/06 | WEIGHT 30 LB. | FROM n/a | DRAWING NUMBER MP-5100-A-001 |

D-SIZE

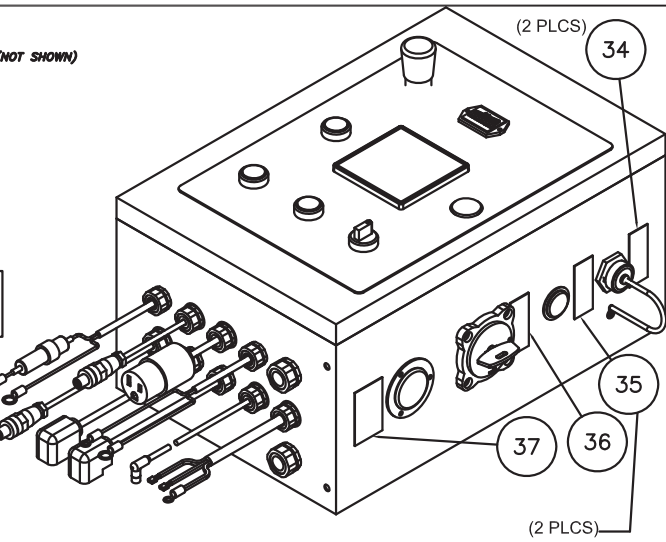
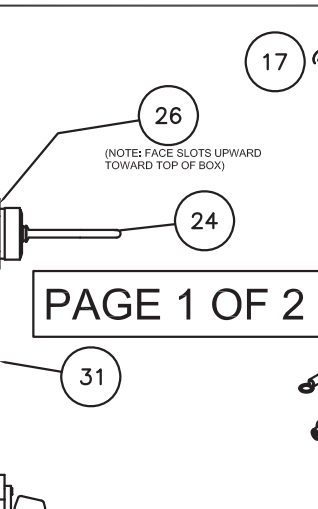
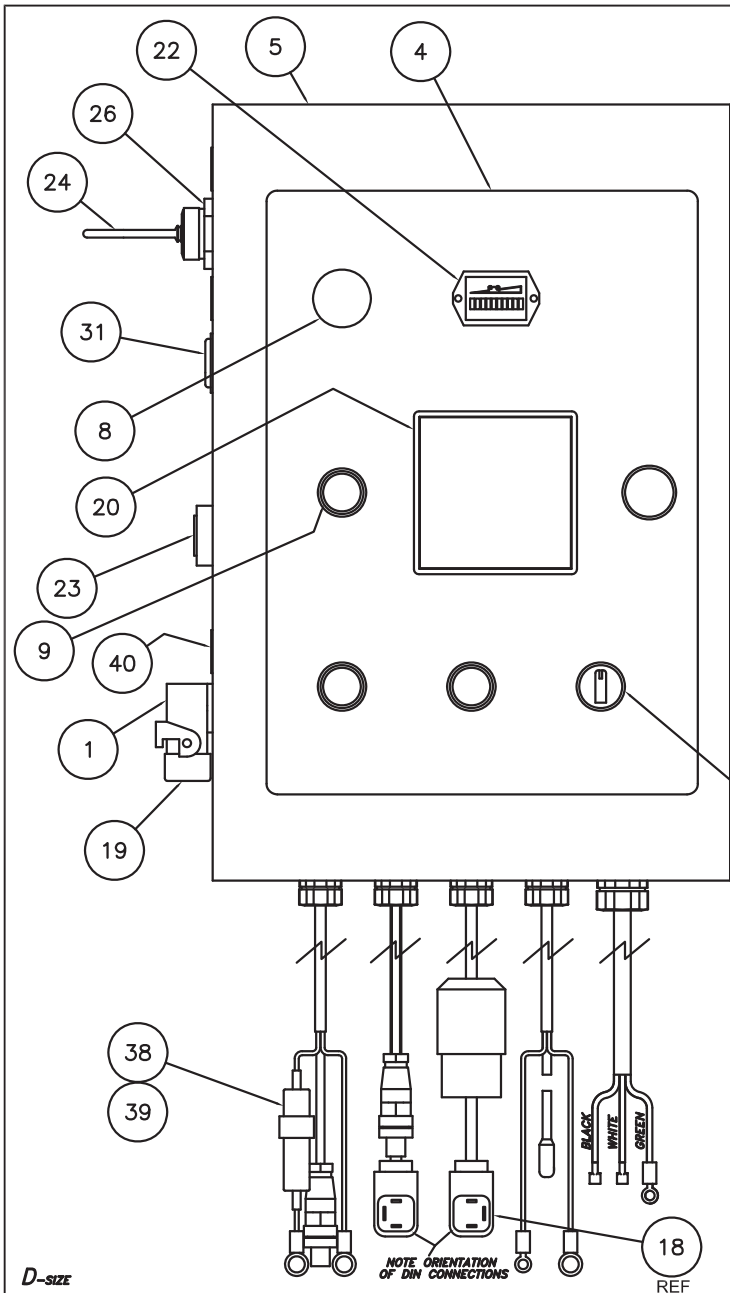

| # | DESCRIPTION | DATE | APPROVED |
|---|---|------------|----------|
| A | ITEM 21 WAS 601-180-200 | 05/28/2007 | dak0879 |
| B | 1. Item 31 was 601-170-015 | 04/18/2007 | rvw7089 |
| B | 2. Item 32 was 601-170-016 | | |
| B | 3. Item 38 & 39 Added | 04/19/2007 | rvw7089 |
| C | Items 2 & 14 were qty 1. | 05/08/2007 | rvw7089 |
| C | Item 22 new supplier | | |
| D | 1. Item 11 was 601-110-088 | 06/18/2007 | rvw7089 |
| D | 2. Item 24 was 601-180-205 | | |
| D | 3. Item 25 was 601-180-206 | 06/18/2007 | rvw7089 |
| D | 4. Item 26 was 601-180-209 | | |
| D | 5. Item 27 was 601-180-210 | 06/18/2007 | rvw7089 |
| D | 6. Item 33 was 601-800-218 | | |
| D | 7. Item 38 was 601-120-111 | 06/18/2007 | rvw7089 |
| D | 8. Item 40 Added | | |
| E | Wire Strip Lengths Added | 09/12/2007 | rvw7089 |
| E | Wiring for Strip Put and Sensor Revised | | |
| F | 1) ITEM 19 WAS 601-180-188 | 10/08/2007 | |
| F | 2) ITEM 12 WAS QTY OF 2 | | |
| F | 3) ITEM 13 WAS QTY OF 3 | | |
| F | 4) ITEM 28 WAS QTY OF 6 | | |
| F | 5) ITEM 41 (601-140-107) ADDED | | |
| F | 6) ITEM 42 (601-150-085) ADDED | | |
| F | 7) ITEM 16 WAS QTY 1 | | |
| F | 8) CHART CHANGED | | |
| F | 9) ITEM 24 WAS INCORRECT | | |
| G | Bottom of Box Port Orientations Revised (See Page 2 of 2) | 06/18/2008 | rvw7089 |
| H | Orientation of Bottom Ports back to REV F. | 06/15/2008 | rvw7089 |
| I | ITEM 11 WAS 601-110-67 | 06/10/2010 | G.GORE |

- 42 601-150-095 Isolated Ring Terminal
- 41 601-140-107 Straight Adapter, Yellow
- 40 601-800-224 Decal, "Hand Pendant Receptacle..."
- 39 601-120-112 Fuse, Type AGC, 20 AMP, 32 V
- 38 601-120-116 Fuse Holder, In-Line, Crimp Style
- 37 601-800-285 Decal, "120 VAC CHARGER INLET"
- 36 601-800-284 Decal, "CHARGE LIFT - OPERATE LIFT"
- 35 601-800-283 Decal, "12 VDC POWER PORT"
- 34 601-800-221 Decal, "COMMUNICATION"
- 33 0
- 32 0
- 31 601-170-017 Outlet, 12 VDC, Marine
- 30 601-170-014 Flanged Inlet with Dust Cover, 3 Pole, 120 VAC, 15 Amp
- 29 601-170-006 Connector, 3 Prong, 15A/120V/1Ph
- 28 601-165-053 Straight Adapter, Red
- 27 0
- 26 601-160-219 Receptacle, DeviceNET, Female
- 25 0
- 24 601-160-221 Closure Cap w/Chain, Mini Male
- 23 601-160-204 Piezo Sound Alarm, 24 VDC, Red
- 22 601-160-203 Battery Gauge, 24 VDC
- 21 601-160-214 Quick-Disconnect Cable
- 20 601-160-198 PLC w/ Display & Buttons (XLE OCS)
- 19 601-160-142 Cover for Female Insert
- 18 601-160-154 DIN Cable Assembly w/ 4' Cable
- 17 601-150-088 Wire Nut, 5 Pole
- 16 601-150-081 Isolated Ring Terminal
- 15 601-150-080 Quick Connect Terminal, 0.187 x 0.020, Fully Insulated
- 14 601-140-071 Circular Connector, 5 Pin, Male
- 13 601-140-064 Straight Adapter, Blue
- 12 601-140-045 Straight Adapter, White
- 11 601-110-071 Switch, ON/OFF, 300 Amp Continuous, KEYED
- 10 601-110-056 Rotary Switch, 3 Position, Return to Center, 22mm
- 9 601-110-055 Push Button, Green, 22mm
- 8 601-110-054 E-Stop Button, Push & Turn, 22mm
- 7 MP-5100-P-408 Cable, Type SJ, 16/3 X 12" Long
- 6 MP-5100-P-407 Cable, Gray Jacketed w/ Red/Blk Wire, 14/2 X 36" Long
- 5 MP-5100-P-402 Master Enclosure Drilling
- 4 MP-5100-P-001 Control Decal, MP-24VDC-Series
- 3 MP-1300-P-403 Cable, 16/3 SOW-A/SO x 5 Feet
- 2 MP-1300-P-402 Cable, Shielded, 6/24 x 7 Feet
- 1 MP-1300-A-009 Pendant Receptacle Assembly

| ITEM | NAME | DESCRIPTION | QTY | MATERIAL | VENDOR | NOTE | MASS | PRICE |
|------|------|-------------|-----|---|-------------------------|---------------|------|--------|
| | | | | T&B RB737 | | | | 0.003 |
| | | | 2 | AMFI #CG75B750 | | | | 0.170 |
| | | | 1 | | | 1" x 3" | | 0.000 |
| | | | 1 | Busman #AGC-20 | | | | 0.050 |
| | | | 1 | Busmann #HFA | | | | 0.010 |
| | | | 1 | | | 1 1/2 x 2 | | 0.000 |
| | | | 1 | | | 1/2 | | 0.000 |
| | | | 2 | | | 1 1/2 x 2 1/2 | | 0.000 |
| | | | 2 | | | 1" x 2 1/2 | | 0.000 |
| | | | 3 | | | 1" x 2 1/2 | | 0.000 |
| | | | 0 | | | | | 0.000 |
| | | | 0 | | | | | 0.000 |
| | | | 2 | Waytak #11020 | | | | 0.100 |
| | | | 1 | Waytak #10342 | | | | 0.500 |
| | | | 1 | NEMA #5-15C | | | | 0.300 |
| | | | 3 | AMFI #CG50A250 | | | | 0.150 |
| | | | 0 | | | | | 0.000 |
| | | | 2 | Turck #RKP 572-1M | | | | 1.500 |
| | | | 0 | | | | | 0.000 |
| | | | 2 | Turck #RSF-CC | | | | 0.637 |
| | | | 1 | Ingram Products Inc. #PW24D-Red | | | | 0.001 |
| | | | 1 | SenDEC #810K-C13-222 (F1-0721) | | | | 0.100 |
| | | | 1 | Automation Direct #CD08-0A-020-C1 | | | | 0.168 |
| | | | 1 | Horner #HE-XE102 | | | | 1.500 |
| | | | 1 | Weland #07.417.6829.0 | | | | 0.070 |
| | | | 2 | (from Monarch PU 601-300-073) | | | | 0.750 |
| | | | 4 | Wago #222-415 | | | | 0.060 |
| | | | 2 | T&B RB877 | | | | 0.003 |
| | | | 2 | Grainner #34F20 | | | | 0.001 |
| | | | 2 | Remmie #305F70 | | | | 0.100 |
| | | | 2 | AMFI #CG50A450 | | | | 0.150 |
| | | | 4 | AMFI #CG50A350 | | | | 0.150 |
| | | | 1 | Blue Sea Systems #6005 | | | | 0.750 |
| | | | 2 | Siemens #3SB3000-2EA11 / (2) 3SB3400-0B | | | | 0.106 |
| | | | 3 | Siemens #3SB3202-0AA41 | | | | 0.106 |
| | | | 1 | Siemens #3SB3000-1HA20/3SB3400-0C | | | | 0.106 |
| | | | 1 | 601-180-045 | | | | 0.500 |
| | | | 2 | 601-150-082 | Waytak #WDRB14-2 | | | 0.500 |
| | | | 1 | Saginaw #18128LP Custom | | | | 15.000 |
| | | | 1 | | | 10" x 14" | | 0.001 |
| | | | 1 | 601-150-061 | Carol #02785 | | | 0.525 |
| | | | 2 | 601-150-060 | Alpha Wire H1 P/N 1216C | | | 0.500 |
| | | | 1 | | | | | 0.250 |

PROVIDED BY MOHAWK - REF

NOTICE OF CONFIDENTIAL INFORMATION

INFORMATION CONTAINED HEREIN IS CONFIDENTIAL AND PROPERTY OF MOHAWK RESOURCES LTD. THESE DRAWINGS OR INFORMATION CONTAINED HEREIN IS TO BE USED ONLY FOR THE PURPOSES OF FABRICATING OR ASSEMBLING THE EQUIPMENT SPECIFIED HEREIN. IT IS TO BE KEPT UNDER LOCK AND KEY AND NOT TO BE DISCLOSED OR REPRODUCED FOR ANY OTHER PURPOSES UNLESS SO INDICATED BY THE ISSUING AUTHORITY.

- NOTES:
- REMOVE ALL SHARP CORNERS & EDGES.
 - UNLESS OTHERWISE SPECIFIED, SURFACE FINISH TO BE 125 RMS.
 - WELDING MEDIUM SHALL CONFORM TO AWS SPECIFICATIONS TO E-CODE ELECTRODES OR E-CODE CODE 5.3 FLUX CORE WIRE ONLY.

TOLERANCES:
 ANGULAR: ±1°
 FRACTIONAL: ±0.030
 DECIMAL: ±0.030
 XXXX: ±0.005

FILE NAME: MP-5100-A-003.dwg

| SCALE | DRAWN | CHECKED | APPROVED | DATE | WEIGHT | FROM | DRAWINGS NUMBER |
|-------|---------|---------|----------|----------|--------|------|-----------------|
| | rvw7089 | | | 11/20/08 | 28.5 | N/A | MP-5100-A-003 |

MOHAWK RESOURCES LTD.

MP-24VDC-SERIES
 Master Enclosure Box Assy

D-size

NOTE ORIENTATION OF DIN CONNECTIONS

18 REF

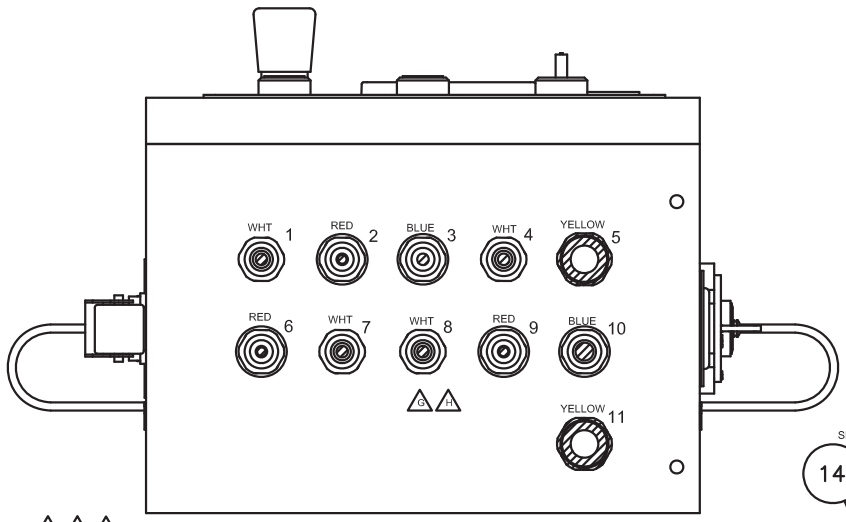

| PORT# | FITTING# | EXPOSED LG | TOTAL LG | DESCRIPTION |
|-------|-----------|----------------|------------|---------------------------------------|
| 1 | 12 (WHT) | 40" (Strip 8") | 72" | 12 VDC POWER OUTLETS TO LEFT BATTERY |
| 2 | 28 (RED) | 12" | 42" | PRESSURE SENSOR |
| 3 | 13 (BLUE) | 12" | 36" | CHARGER POWER CABLE TO 120 VAC OUTLET |
| 4 | 12 (WHT) | 24" (Strip 8") | 51" | MOTOR CONTACTOR & MAIN GROUND |
| 5 | 41 (YEL) | 40" | 50" | ON/OFF (+) TO RIGHT BATTERY (+) |
| 6 | 28 (RED) | 96" | 126" | LINEAR TRANSDUCER (YO-YO) |
| 7 | 12 (WHT) | 18" | Factory Lg | 50% DOWN SOLENOID (LEFT) |
| 8 | 12 (WHT) | 18" | Factory Lg | 100% DOWN SOLENOID (RIGHT) |
| 9 | 28 (RED) | 60" | Factory Lg | PROXIMITY SENSOR @ LOCK |
| 10 | 13 (BLUE) | 60" (Strip 5") | 80" | LOCK SOLENOID |
| 11 | 41 (YEL) | 20" | 48" | FROM 150A C/B (+) TO MOTOR SOLE |

WIRING:
String Pot:
Pin #1: Red
Pin #2: Black
n/c: White
n/c: Shield

Pressure Sensor:
Pin #1: Red
Pin #2: Black
n/c: White
n/c: Shield

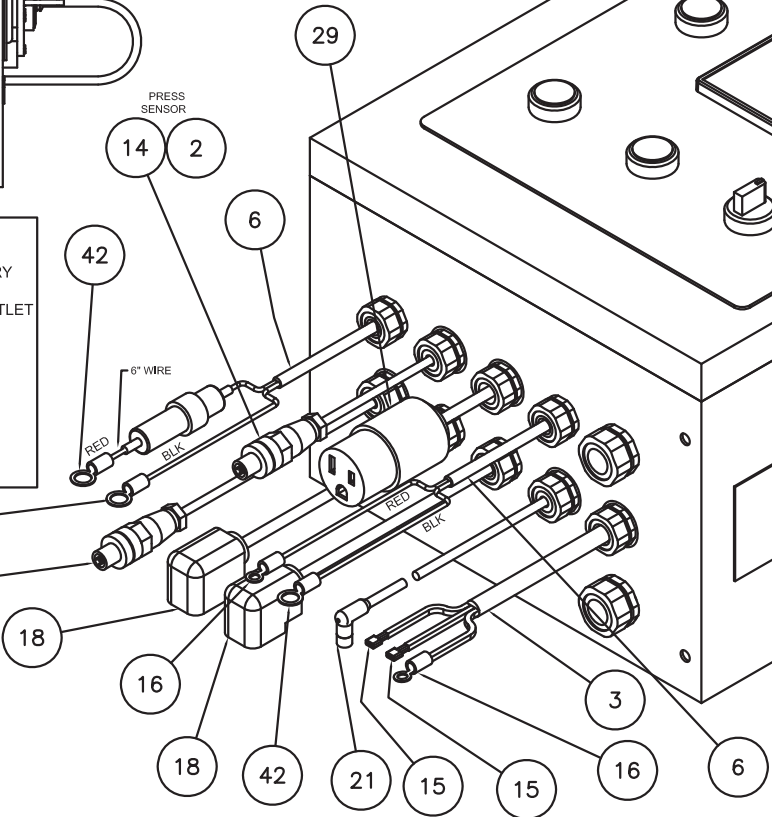
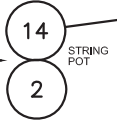

PAGE 2 OF 2

NOTICE OF CONFIDENTIAL INFORMATION
INFORMATION CONTAINED HEREIN IS CONFIDENTIAL AND PROPERTY OF MOHAWK RESOURCES LTD. IT IS TO BE KEPT STRICTLY CONFIDENTIAL AND NOT TO BE USED OR DISCLOSED IN ANY MANNER WITHOUT THE WRITTEN PERMISSION OF MOHAWK RESOURCES LTD. IT IS TO BE USED ONLY FOR THE PURPOSES SPECIFIED IN THE ORDER OR AS OTHERWISE SPECIFIED BY THE BUYER.

NOTES:
1. REMOVE ALL SHARP CORNERS & EDGES.
2. UNLESS OTHERWISE SPECIFIED, SURFACE FINISH TO BE 125 RMS.
3. WELDING MEDIUM SHALL CONFORM TO AWS SPECIFICATIONS TO E-70XX ELECTRODES OR E-70TI CODE 5.3 FLUX CORE WIRE ONLY.

TOLERANCES:
ANGULAR: ± 1 °
FRACTIONAL: ± .030
DECIMAL: ± .030
E-XXX: ± .065
FILE NAME: MP-5100-A-003.dwg

| | | |
|------------------|--------------------|---|
| SCALE | DRAWN rww7089 | MOHAWK RESOURCES LTD. |
| CHECKED | APPROVED | TITLE MP-24VDC-SERIES Master Enclosure Box Assy |
| DATE 11/28/06 | WEIGHT 26.5 LB. | FROM N/A |
| MP-5100-A-001 | NEXT ASSEMBLY | DRAWING NUMBER MP-5100-A-003 |

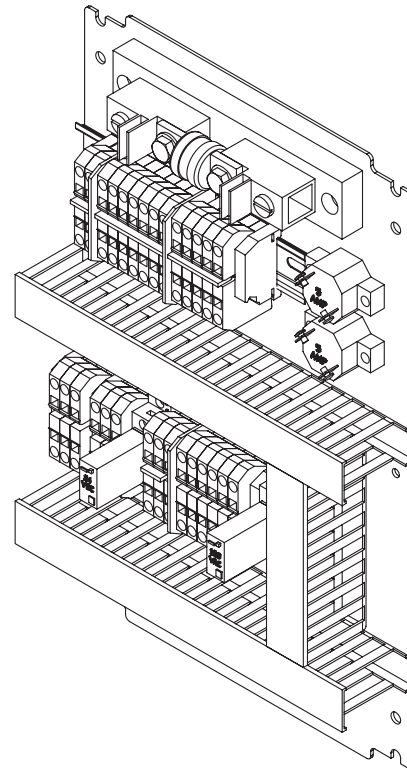
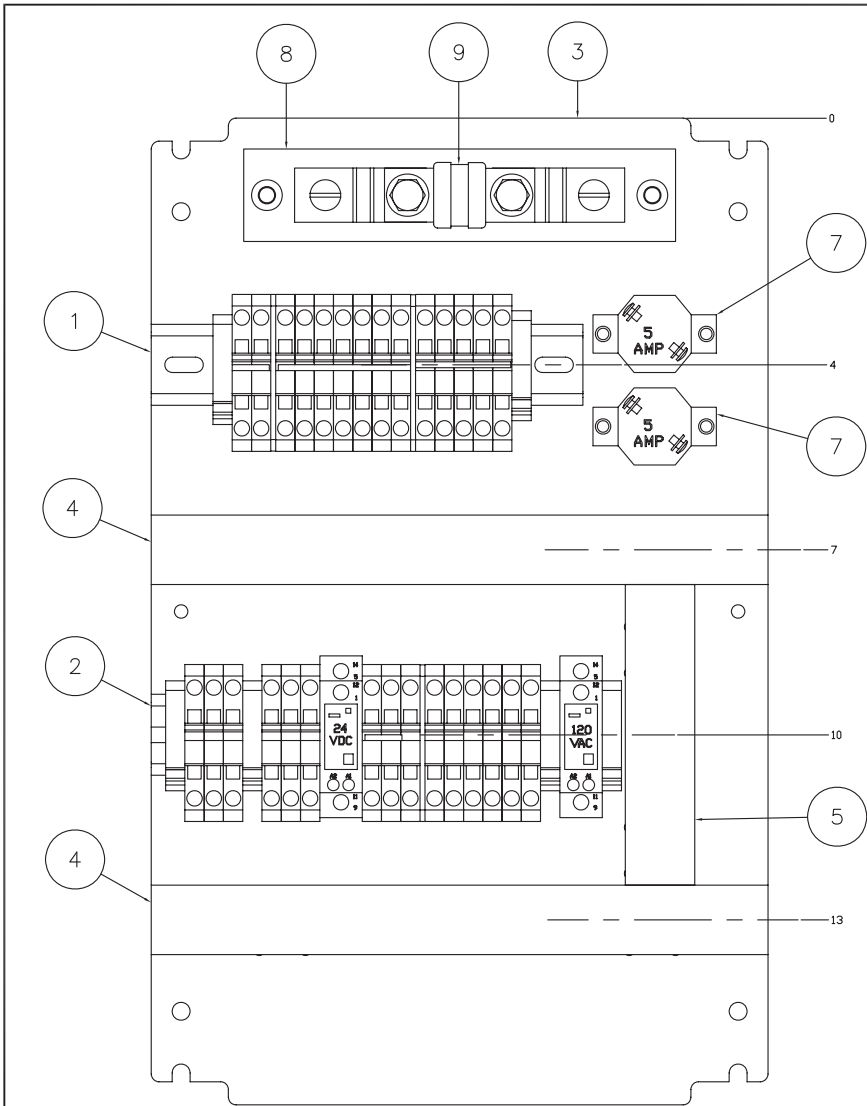

| # | DESCRIPTION | DATE | APPROVED |
|---|--|------------|----------|
| A | 1. Item 5 was 601-130-113. | 06/18/2007 | rwv7089 |
| | 2. Item 6 was 601-120-109. (qty2) | | |
| | 3. Item 7 was 601-120-107. | 06/18/2007 | rwv7089 |
| | 4. Item 8 was MP-5100-P-015. | | |
| B | 1. Item 6 was 601-120- (was 150 Amp Circuit Breaker) | 08/15/2008 | rwv7089 |
| | 2. Item 8 & 9 Added | 08/15/2008 | rwv7089 |

| 9 | 601-120-117 | Fuse, 200 Amp, Fast Acting, Class T | 1 |
|------|---------------|---|-----|
| 8 | 601-120-118 | Fuse Holder, 200 Amp, Class T | 1 |
| 7 | 601-120-115 | Circuit Breaker, 5 Amp, Auto Reset | 2 |
| 6 | | | 0 |
| 5 | MP-5100-P-015 | Wire Ducting, 1" x 2" High x 4 7/8 Long | 1 |
| 4 | MP-5100-P-014 | Wire Ducting, 1" x 2" High x 10" Long | 2 |
| 3 | MP-5100-P-004 | Panel Drilling | 1 |
| 2 | MP-5100-A-021 | Terminal Strip Assy #2, TR-Series | 1 |
| 1 | MP-5100-A-020 | Terminal Strip Assy #1 | 1 |
| ITEM | NAME | DESCRIPTION | QTY |

Parts List

NOTICE OF CONFIDENTIAL INFORMATION

INFORMATION CONTAINED HEREIN IS CONFIDENTIAL AND PROPERTY OF MOHAWK RESOURCES LTD., WHERE DRAWING IS FURNISHED TO OTHERS IT SHALL BE USED SOLELY FOR PURPOSES OF INSPECTION, INSTALLATION, OR MAINTENANCE. THE INFORMATION SHALL NOT BE USED OR DISCLOSED BY THE RECIPIENT FOR ANY OTHER PURPOSES WHATSOEVER.

NOTES:
 1. REMOVE ALL SHARP CORNERS & EDGES.
 2. UNLESS OTHERWISE SPECIFIED, SURFACE FINISH TO BE 125 RMS.
 3. WELDING MEDIUM SHALL CONFORM TO AWS SPECIFICATIONS TO E-70XX ELECTRODES OR E-70TT CODE S.3 FLUX CORE WIRE ONLY.

TOLERANCES:
 ANGULAR ± 1°
 FRACTIONAL ± .030
 DECIMAL 0.XXX ± .005
 0.XXX ± .005

FILE NAME: MP-5100-A-004

| | | | |
|------------------|------------------|---|---------------------------------|
| SCALE 1/2 | DRAWN rwv7089 | MOHAWK RESOURCES LTD. | |
| CHECKED | APPROVED | TITLE MP-24VDC-SERIES Master Panel Assy | |
| DATE 11/30/06 | WEIGHT 15 LB. | FROM n/a | DRAWING NUMBER MP-5100-A-004 |
| NEXT ASSEMBLY | | | |

PANZITTA SALES & SERVICE
72 George Avenue
Wilkes-Barre, PA 18705
570-822-6720 800-822-6720
www.panzittasales.com

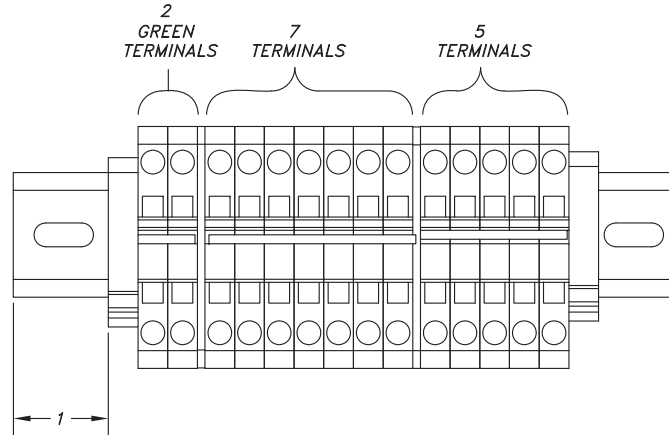
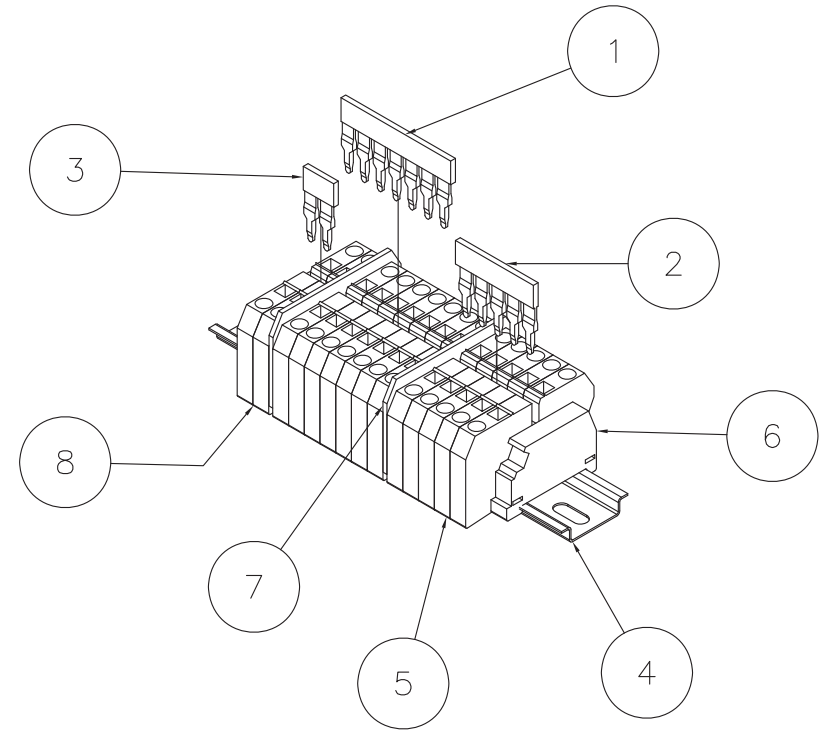

| 8 | 601-165-068 | Terminal Block, Screwless, Green (For Grounding) | 2 |
|------|---------------|--|-----|
| 7 | 601-165-063 | End Cover, Screwless Terminal Strip | 2 |
| 6 | 601-165-061 | End Stop | 2 |
| 5 | 601-165-059 | Terminal Block, Screwless, Grey | 12 |
| 4 | MP-5100-P-009 | Din Rail, 7 Lg | 1 |
| 3 | MP-5100-P-013 | Top Jumper Bar, 2 Pole, Screwless | 1 |
| 2 | MP-5100-P-012 | Top Jumper Bar, 5 Pole, Screwless | 1 |
| 1 | MP-5100-P-011 | Top Jumper Bar, 7 Pole, Screwless | 1 |
| ITEM | NAME | DESCRIPTION | QTY |

Parts List

C-SIZE

NOTICE OF CONFIDENTIAL INFORMATION

INFORMATION CONTAINED HEREIN IS CONFIDENTIAL AND PROPERTY OF MOHAWK RESOURCES LTD.. WHERE DRAWING IS FURNISHED TO OTHERS IT SHALL BE USED SOLELY FOR PURPOSES OF INSPECTION, INSTALLATION, OR MAINTENANCE. THE INFORMATION SHALL NOT BE USED OR DISCLOSED BY THE RECIPIENT FOR ANY OTHER PURPOSES WHATSOEVER.

NOTES:

1. REMOVE ALL SHARP CORNERS & EDGES.
2. UNLESS OTHERWISE SPECIFIED, SURFACE FINISH TO BE 125 RMS.
3. WELDING MEDIUM SHALL CONFORM TO AWS SPECIFICATIONS TO E-70XX ELECTRODES OR E-70TI CODE 5.3 FLUX CORE WIRE ONLY.

TOLERANCES:
 ANGULAR ± 1°
 FRACTIONAL ± .030
 DECIMAL:
 0.XX ± .030
 0.XXX ± .005

FILE NAME
 MP-5100-A-020

MP-5100-A-
 MP-5100-A-
 NEXT ASSEMBLY

SCALE
 3/4
 CHECKED
 DATE
 11/27/06

DRAWN
 rww7089
 APPROVED
 WEIGHT
 1.4 LB.

MOHAWK RESOURCES LTD.

TITLE
 MP-24VDC-SERIES
 Terminal Strip Assy #1

FROM
 n/a
 DRAWING NUMBER
 MP-5100-A-020



| # | DESCRIPTION | DATE | APPROVED |
|---|-----------------------------------|------------|----------|
| A | 1) ONE ITEM 5 (601-165-059) ADDED | 03/27/2007 | |
| | 2) ITEM 9 (601-160-215) ADDED | | |
| | 3) ITEM 10 (601-160-216) ADDED | 03/27/2007 | dak0879 |
| | 4) Item 1 was 8 3/4 Long | | |

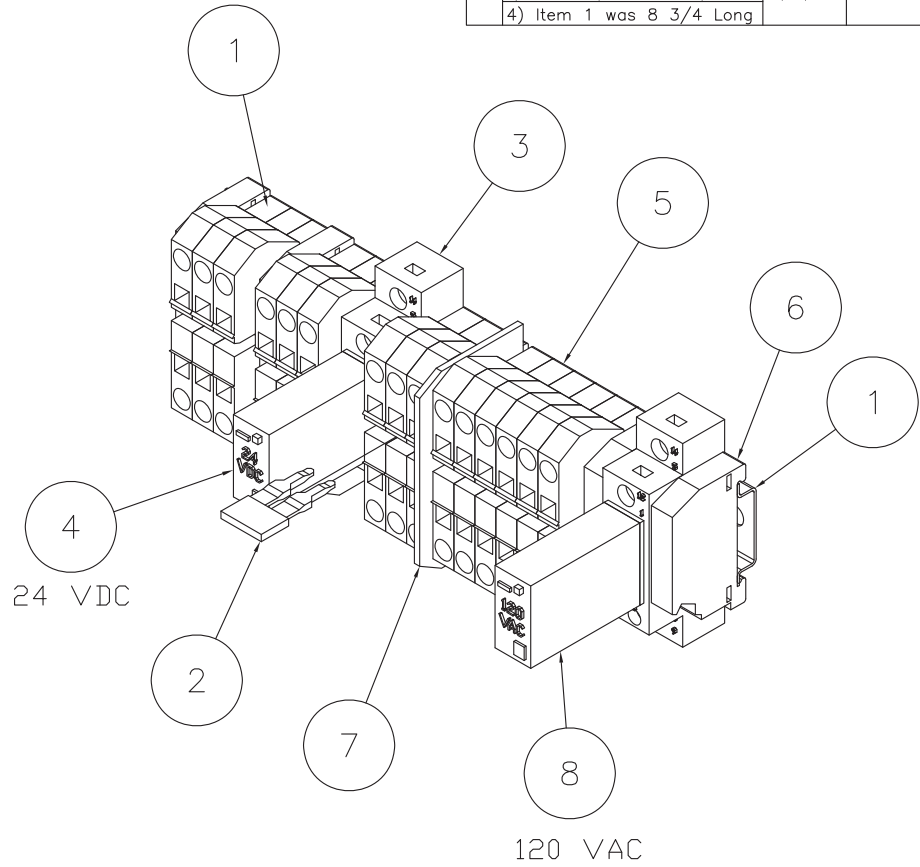
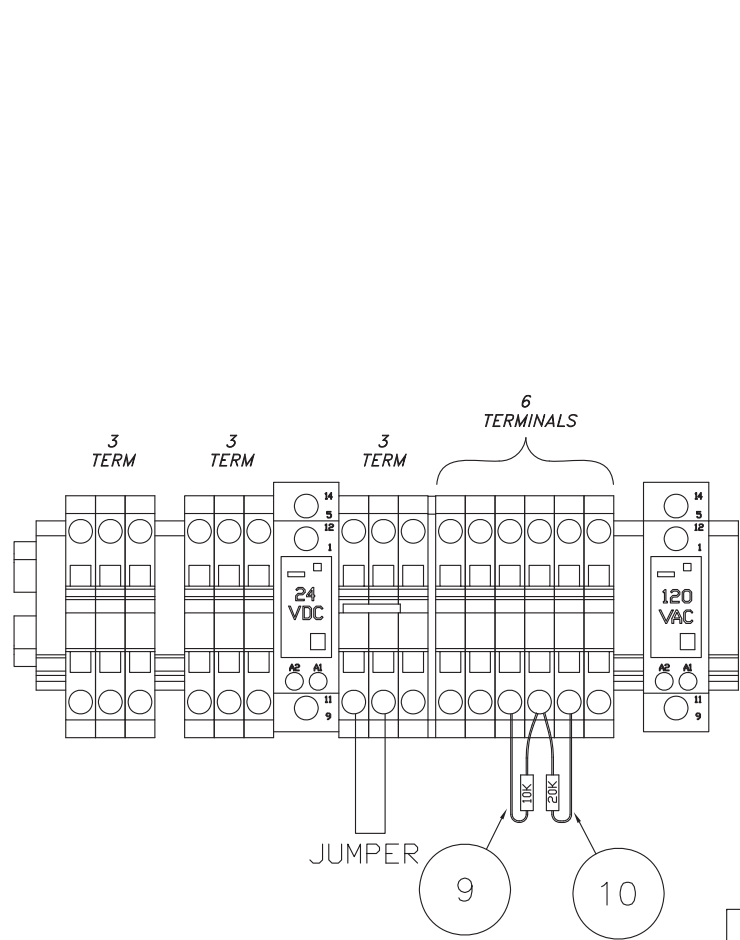

| 10 | 601-160-216 | Resistor, 20k Ohm | 1 |
|------|---------------|--|-----|
| 9 | 601-160-215 | Resistor, 10k Ohm | 1 |
| 8 | 601-160-144 | Relay, Miniature, SPDT, 15 A, 120 VAC Coil, LED w/Bypass | 1 |
| 7 | 601-165-063 | End Cover, Screwless Terminal Strip | 1 |
| 6 | 601-165-061 | End Stop | 4 |
| 5 | 601-165-059 | Terminal Block, Screwless, Grey | 15 |
| 4 | 601-160-196 | Relay, Miniature, SPDT, 15 A, 24 VDC Coil, LED w/Bypass | 1 |
| 3 | 601-160-146 | Relay Socket, Screw Terminal | 2 |
| 2 | MP-5100-P-013 | Top Jumper Bar, 2 Pole, Screwless | 1 |
| 1 | MP-5100-P-010 | Din Rail, 7 5/8 Lg | 1 |
| ITEM | NAME | DESCRIPTION | QTY |

Parts List

C-SIZE

NOTICE OF CONFIDENTIAL INFORMATION

INFORMATION CONTAINED HEREIN IS CONFIDENTIAL AND PROPERTY OF MOHAWK RESOURCES LTD.. WHERE DRAWING IS FURNISHED TO OTHERS IT SHALL BE USED SOLELY FOR PURPOSES OF INSPECTION, INSTALLATION, OR MAINTENANCE. THE INFORMATION SHALL NOT BE USED OR DISCLOSED BY THE RECIPIENT FOR ANY OTHER PURPOSES WHATSOEVER.

NOTES:
 1. REMOVE ALL SHARP CORNERS & EDGES.
 2. UNLESS OTHERWISE SPECIFIED, SURFACE FINISH TO BE 125 RMS.
 3. WELDING MEDIUM SHALL CONFORM TO AWS SPECIFICATIONS TO E-70XX ELECTRODES OR E-70TI CODE 5.3 FLUX CORE WIRE ONLY.

TOLERANCES:
 ANGULAR ± 1°
 FRACTIONAL ± .030
 DECIMAL:
 0.XX ± .030
 0.XXX ± .005

FILE NAME
 MP-5100-A-021

MP-5100-A-
 MP-5100-A-
 NEXT ASSEMBLY

SCALE
 3/4

CHECKED
 DATE
 11/27/06

DRAWN
 rww7089

APPROVED
 WEIGHT
 1.4 LB.

MOHAWK RESOURCES LTD.

TITLE
 MP-24VDC-SERIES
 Terminal Strip Assy #2

FROM
 n/a

DRAWING NUMBER
 MP-5100-A-021



| # | DESCRIPTION | DATE | APPROVED |
|---|-------------------------------|------------|----------|
| A | HARDWARE CHANGED TO LOCK NUTS | 08/18/2011 | rwv7089 |

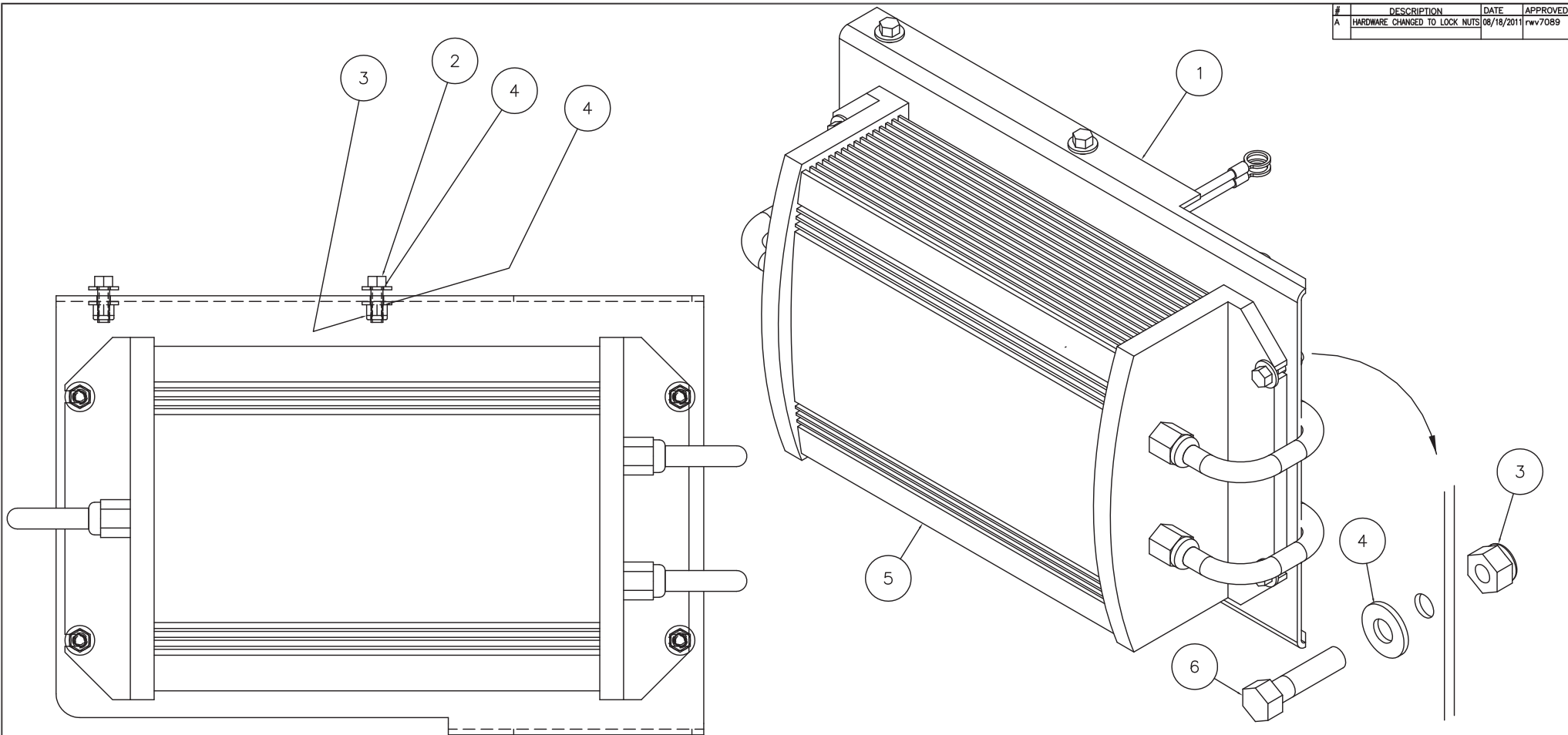

| ITEM | NAME | DESCRIPTION | QTY |
|------|---------------|---|-----|
| 6 | 600-640-004 | Bolt, Hex Head, 1/4-20 NC x 1" (GR5) | 4 |
| 5 | 601-160-270 | Battery Charger, 20 Amp, Dual 12 VDC Output | 1 |
| 4 | 600-710-004 | Washer, Flat, 1/4 | 8 |
| 3 | 600-690-005 | Nut, Nylon Lock, 1/4-20 NC | 6 |
| 2 | 600-640-013 | Bolt, Hex Head, 1/4-20 NC x 3/4 (GR5) | 2 |
| 1 | MP-5100-P-025 | Charger Mounting Bracket | 1 |

NOTICE OF CONFIDENTIAL INFORMATION

INFORMATION CONTAINED HEREIN IS CONFIDENTIAL AND PROPERTY OF MOHAWK RESOURCES LTD. WHERE DRAWING IS FURNISHED TO OTHERS IT SHALL BE USED SOLELY FOR PURPOSES OF INSPECTION, INSTALLATION, OR MAINTENANCE. THE INFORMATION SHALL NOT BE USED OR DISCLOSED BY THE RECIPIENT FOR ANY OTHER PURPOSES WHATSOEVER.

NOTES:
 1. REMOVE ALL SHARP CORNERS & EDGES.
 2. UNLESS OTHERWISE SPECIFIED, SURFACE FINISH TO BE 125 RMS.
 3. WELDING MEDIUM SHALL CONFORM TO AWS SPECIFICATIONS TO E-70XX ELECTRODES OR E-70TTI CODE S3 FLUX CORE WIRE ONLY.

TOLERANCES:
 ANGULAR ± 1°
 FRACTIONAL ± .030
 DECIMAL 0.XXX ± .005
 0.XXX ± .005

FILE NAME: MP-5100-A-012
 NEXT ASSEMBLY

| | | | |
|---------------|-------------------|-------------------------------------|-------------------------------|
| SCALE: 1=1 | DRAWN: G.GORE | MOHAWK RESOURCES LTD. | |
| CHECKED: | APPROVED: | TITLE: MP-1B 24VDC Charger Assembly | |
| DATE: 8/01/11 | WEIGHT: 24.75 LB. | FROM: n/a | DRAWING NUMBER: MP-5100-A-012 |

D-SIZE

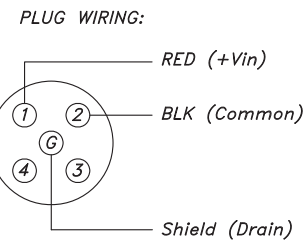
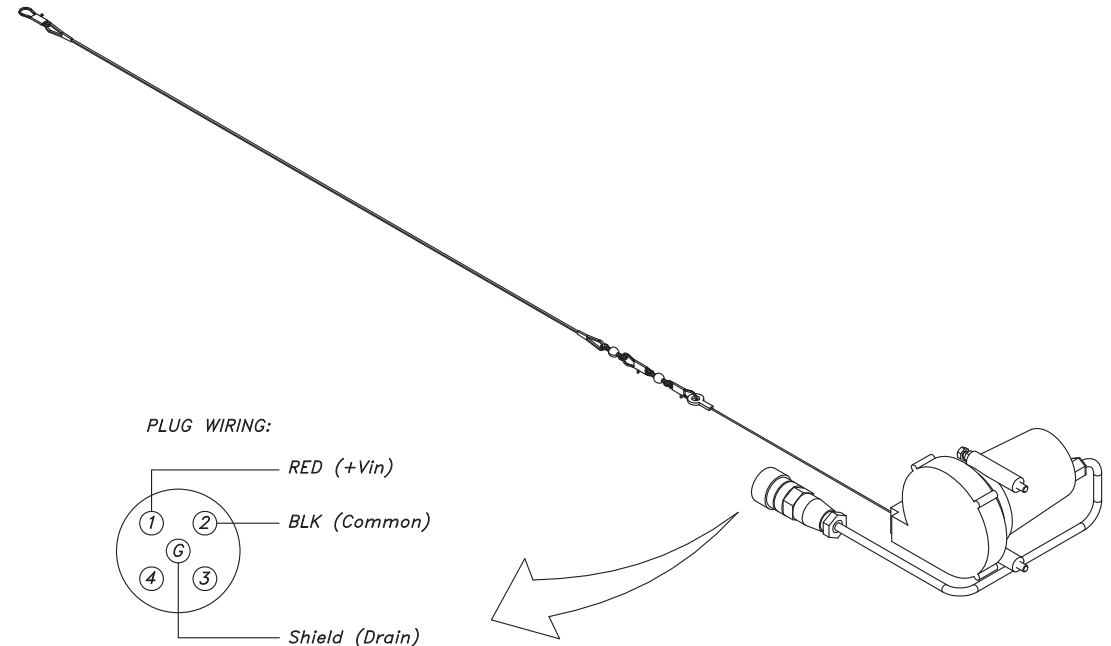
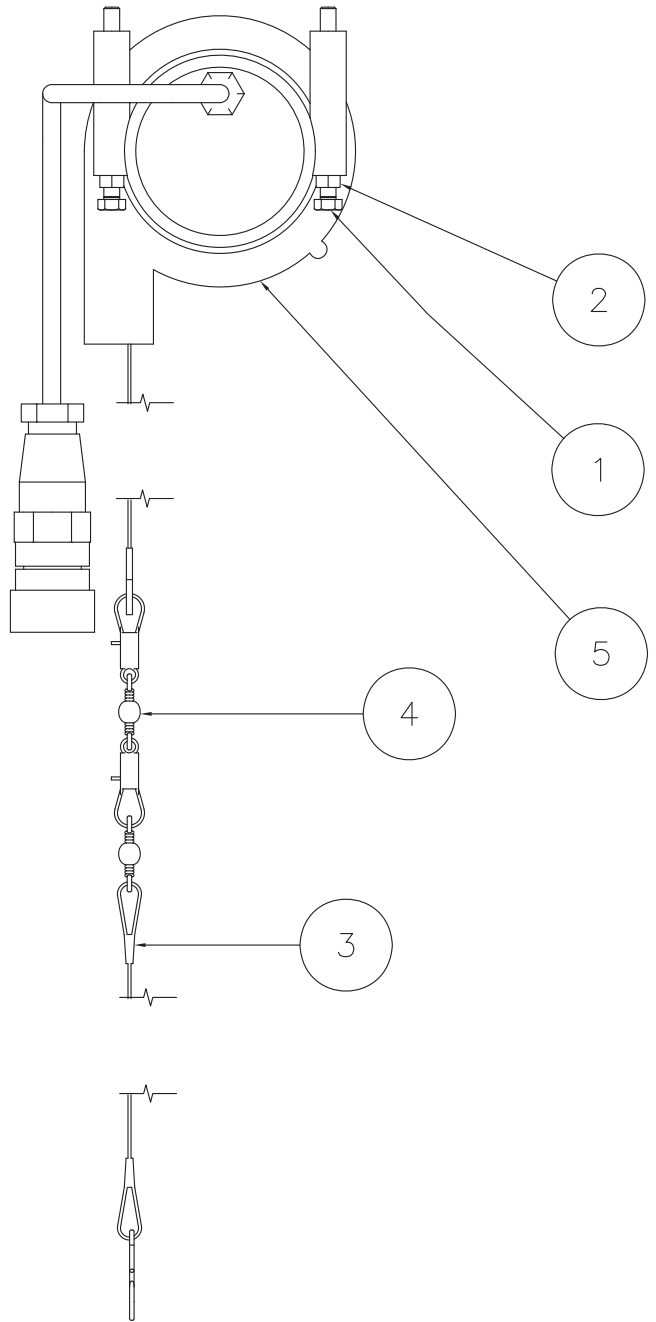

| 5 | 601-160-201 | Linear Position Sensor, NEMA 4X, ANALOG | 1 |
|------------|-------------|---|-----|
| 4 | 600-850-019 | Double Swivel | 1 |
| 3 | 600-850-018 | Leader Line, 18" Long | 1 |
| 2 | 600-680-028 | Nut, Plain, #8-32 NC | 2 |
| 1 | 600-600-021 | Hex Machine Screw, #8-32NC x 2" Lg | 2 |
| ITEM | NAME | DESCRIPTION | QTY |
| Parts List | | | |

C-SIZE

NOTICE OF CONFIDENTIAL INFORMATION

INFORMATION CONTAINED HEREIN IS CONFIDENTIAL AND PROPERTY OF MOHAWK RESOURCES LTD., WHERE DRAWING IS FURNISHED TO OTHERS IT SHALL BE USED SOLELY FOR PURPOSES OF INSPECTION, INSTALLATION, OR MAINTENANCE. THE INFORMATION SHALL NOT BE USED OR DISCLOSED BY THE RECIPIENT FOR ANY OTHER PURPOSES WHATSOEVER.

NOTES:

- REMOVE ALL SHARP CORNERS & EDGES.
- UNLESS OTHERWISE SPECIFIED, SURFACE FINISH TO BE 125 RMS.
- WELDING MEDIUM SHALL CONFORM TO AWS SPECIFICATIONS TO E-70XX ELECTRODES OR E-70TI CODE 5.3 FLUX CORE WIRE ONLY.

TOLERANCES:

ANGULAR: ± 1°
 FRACTIONAL: ± .030
 DECIMAL: ± .030
 0.XXX ± .005

FILE NAME: MP-5100-A-014.dwg

MP-5400-A-002

MP-5400-A-001

NEXT ASSEMBLY

SCALE: 1"0"=1'0"

CHECKED: DATE: 11/2/2004

WEIGHT: 0.70 LB.

DRAWN: rvv7089

APPROVED:

FROM: N/A

DRAWING NUMBER: MP-5100-A-014

MOHAWK RESOURCES LTD.

TITLE: Mobile Post Lift String Pot Assembly, ANALOG



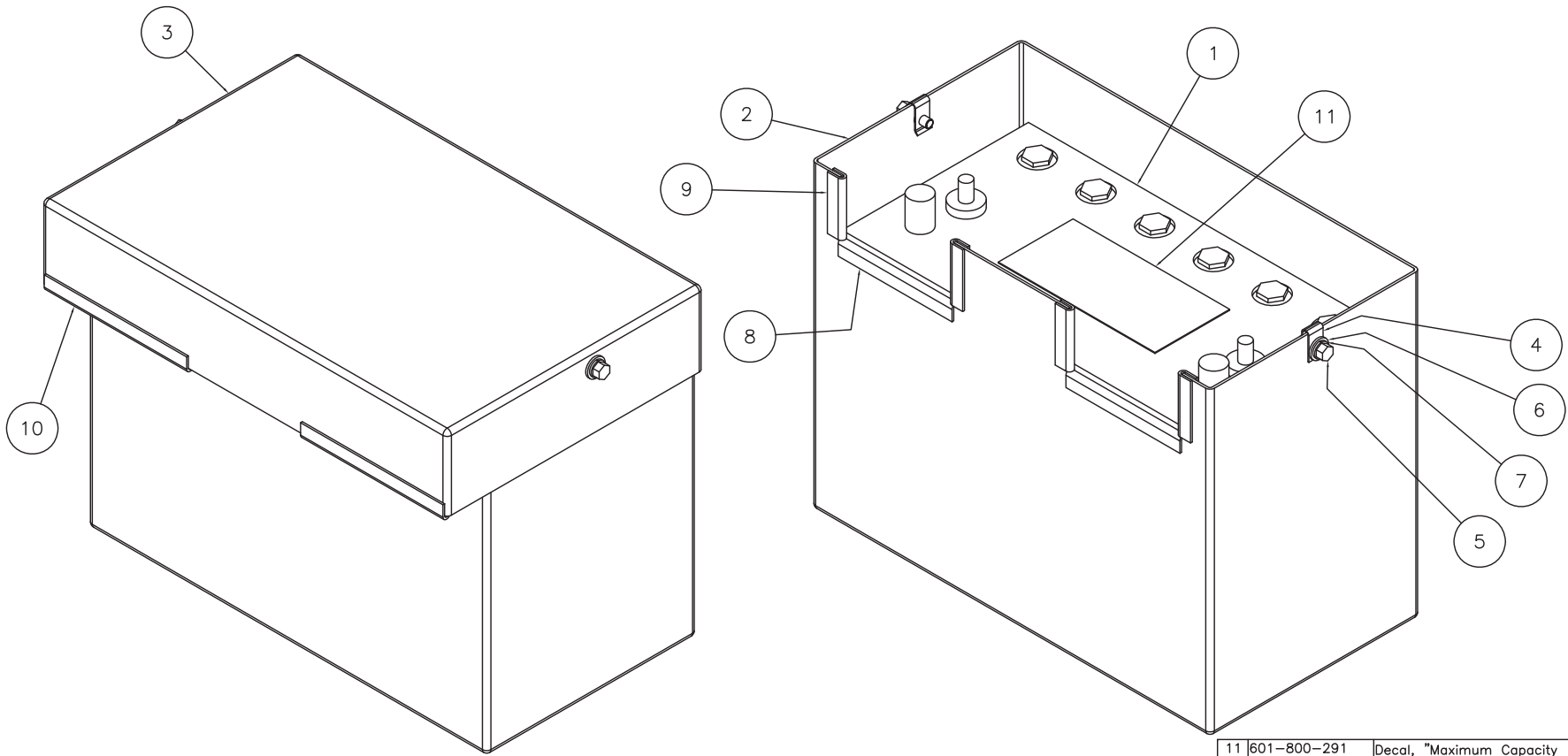

| 11 | 601-800-291 | Decal, "Maximum Capacity 18000 LBS" | 1 |
|------|---------------|---|-----|
| 10 | MP-5300-P-405 | Trim Molding, 5" Long, 1/16 Sheet Metal | 2 |
| 9 | MP-5300-P-404 | Trim Molding, 1 7/8" Long, 1/16 Sheet Metal | 4 |
| 8 | MP-5300-P-403 | Trim Molding, 4" Long, 1/16 Sheet Metal | 2 |
| 7 | 600-720-007 | Washer, Lock, 1/4 | 2 |
| 6 | 600-710-004 | Washer, Flat, 1/4 | 2 |
| 5 | 600-640-042 | Bolt, Hex Head, 1/4-20 NC x 1/2 (GR5) | 2 |
| 4 | 601-200-010 | U-Nut, Automotive, 1/4-20 | 2 |
| 3 | MP-5300-P-004 | Battery Box Top | 1 |
| 2 | MP-5300-P-003 | Battery Box Bottom | 1 |
| 1 | 601-190-011 | Battery, 12VDC | 1 |
| ITEM | NAME | DESCRIPTION | QTY |

Parts List

NOTICE OF CONFIDENTIAL INFORMATION

INFORMATION CONTAINED HEREIN IS CONFIDENTIAL AND PROPERTY OF MOHAWK RESOURCES LTD., WHERE DRAWING IS FURNISHED TO OTHERS IT SHALL BE USED SOLELY FOR PURPOSES OF INSPECTION, INSTALLATION, OR MAINTENANCE. THE INFORMATION SHALL NOT BE USED OR DISCLOSED BY THE RECIPIENT FOR ANY OTHER PURPOSES WHATSOEVER.

NOTES:
 1. REMOVE ALL SHARP CORNERS & EDGES.
 2. UNLESS OTHERWISE SPECIFIED, SURFACE FINISH TO BE 125 RMS.
 3. WELDING MEDIUM SHALL CONFORM TO AWS SPECIFICATIONS TO E-70XX ELECTRODES OR E-7011 CODE, S3 FLUX CORE WIRE ONLY.

TOLERANCES:
 ANGULAR ± 1°
 FRACTIONAL ± .030
 DECIMAL ± .030
 0.XXX ± .005
 FILE NAME: MP-5300-A-001

| | | | | | |
|---------------|------|----------|----------|-----------------------|---------------|
| SCALE | 3/4 | DRAWN | rwv7089 | MOHAWK RESOURCES LTD. | |
| CHECKED | | APPROVED | | TITLE | |
| | | | | Battery Box Assembly | |
| DATE | 4/07 | WEIGHT | 85.6 LB. | FROM | n/a |
| NEXT ASSEMBLY | | | | DRAWING NUMBER | MP-5300-A-001 |

D-SIZE

CERTIFIABLE OPTION WITH X-PROOF PENDANT.

| # | DESCRIPTION | DATE | APPROVED |
|---|--------------------------|------------|----------|
| A | 1.ITEM 1 WAS 601-160-138 | 11/29/2006 | dak |

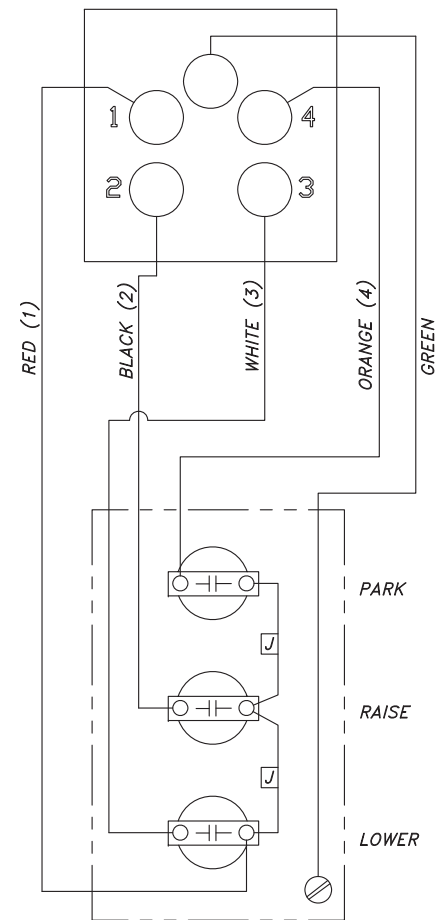
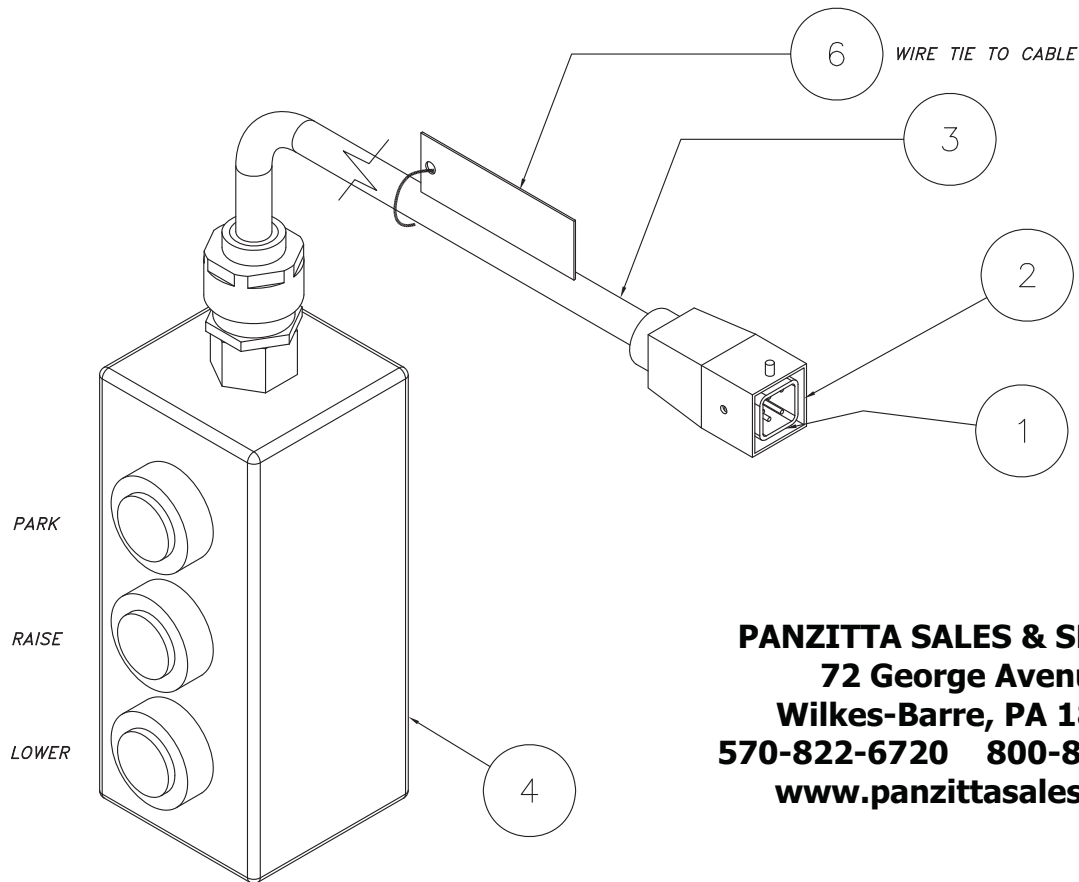

PANZITTA SALES & SERVICE
72 George Avenue
Wilkes-Barre, PA 18705
570-822-6720 800-822-6720
www.panzittasales.com

| 6 | 601-800-223 | Plastic Tag, "Hand Pendant Option..." | 1 |
|------------|-------------|--|-----|
| 5 | 601-140-046 | Connector, 1/2 NPT, 1/2"-5/8" Cable (Brown) | 1 |
| 4 | 601-160-168 | Pendant, 3 Button, Class I, Div 2 | 1 |
| 3 | 601-150-082 | Cable, 18/5 SOW x 25 Feet | 1 |
| 2 | 601-160-139 | Hood, Straight, Metallic w/ cable gland, PENDANT | 1 |
| 1 | 601-160-193 | 4-Pin Insert, Male, PENDANT | 1 |
| ITEM | NAME | DESCRIPTION | QTY |
| Parts List | | | |



C-SIZE

NOTICE OF CONFIDENTIAL INFORMATION

INFORMATION CONTAINED HEREIN IS CONFIDENTIAL AND PROPERTY OF MOHAWK RESOURCES LTD., WHERE DRAWING IS FURNISHED TO OTHERS IT SHALL BE USED SOLELY FOR PURPOSES OF INSPECTION, INSTALLATION, OR MAINTENANCE. THE INFORMATION SHALL NOT BE USED OR DISCLOSED BY THE RECIPIENT FOR ANY OTHER PURPOSES WHATSOEVER.

NOTES:

- REMOVE ALL SHARP CORNERS & EDGES.
- UNLESS OTHERWISE SPECIFIED, SURFACE FINISH TO BE 125 RMS.
- WELDING MEDIUM SHALL CONFORM TO AWS SPECIFICATIONS TO E-70XX ELECTRODES OR E-70TI CODE 5.3 FLUX CORE WIRE ONLY.

TOLERANCES:
 ANGULAR: ± 1°
 FRACTIONAL: ± .030
 DECIMAL:
 0.XX ± .030
 0.XXX ± .005

FILE NAME
 MP-1300-A-020.dwg

NEXT ASSEMBLY

SCALE
 1"0"=1'0"

CHECKED

DATE
 10/10/2005

DRAWN
 rrv7089

APPROVED

WEIGHT
 3 LB.

MOHAWK RESOURCES LTD.

TITLE *Mobile Post Lift
 Pendant Assembly*

FROM
 N/A

DRAWING NUMBER
 MP-1300-A-020

